

台式不锈钢锯骨机 SO S.S START



SO 1650 S.S START

性价比高 与 SO 1650 S.S所用材质、功率、特征等完全一致，主要区别在于废料收集槽内，门是一体式的；降低了生产成本，但又没有改变产品品质；

机器特征 304不锈钢机身，锯条张紧度由系统自动调节。

使用方便 在该级别的机型上，唯一可将上滑轮进行拆卸并清洁的机器。

Cost saving solution Packing the same good amount of performance of the enhanced models but saving on costs by removing features not essential to machine performance, such as the waste collecting tray;

Well build Full AISI 304 stainless steel body to withstand heavy-duty operations with automatic blade tensioning system;

User-friendly The only one in his class to feature a fully detachable upper pulley;

- AISI 304 不锈钢制造；
- 抛光铝合金滑轮；
- 滑轮带密封轴承；
- 带密封圈保护的马达；
- 上部滑轮易拆装，便于清洁和更换刀片；
- 白色刮片易更换；
- 强力风冷马达，适于连续操作；
- IP 67 不锈钢保护级，24伏控制。

- AISI 304 stainless steel construction
- Polished aluminium calibrated pulleys
- Sealed powerful asynchronous motor
- Quick release mechanism for the upper pulley
- Easy removable and replaceable blade scrapers
- Easy cleaning and sanitizing operation
- Equipped with 16mm wide tempered blade
- IP67 stainless steel controls, 24 V

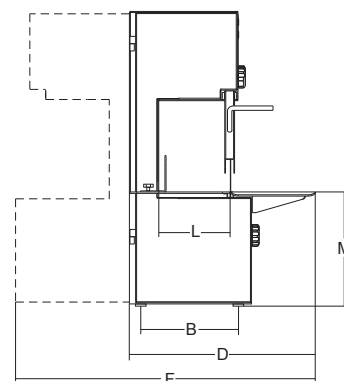
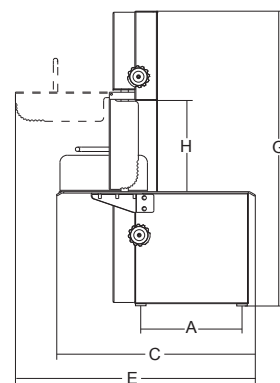

产品型号	电机功率	电源	转速	锯条周长	滑轮	加工表面	A	B	C	D	E	F	G	H	L	M	净重	包装尺寸	毛重
	W / Hp		r.p.m.	mm	mm	mm	mm	mm	mm	mm	mm	mm	mm	mm	mm	mm	kg	mm	kg
SO 1650 S.S START	1103 / 1.5	230V / 50Hz 单相	1400	1650	210	400 x 450	315	314	535	520	640	862	815	249	197	320	46	570 x 720 x 1020	58