

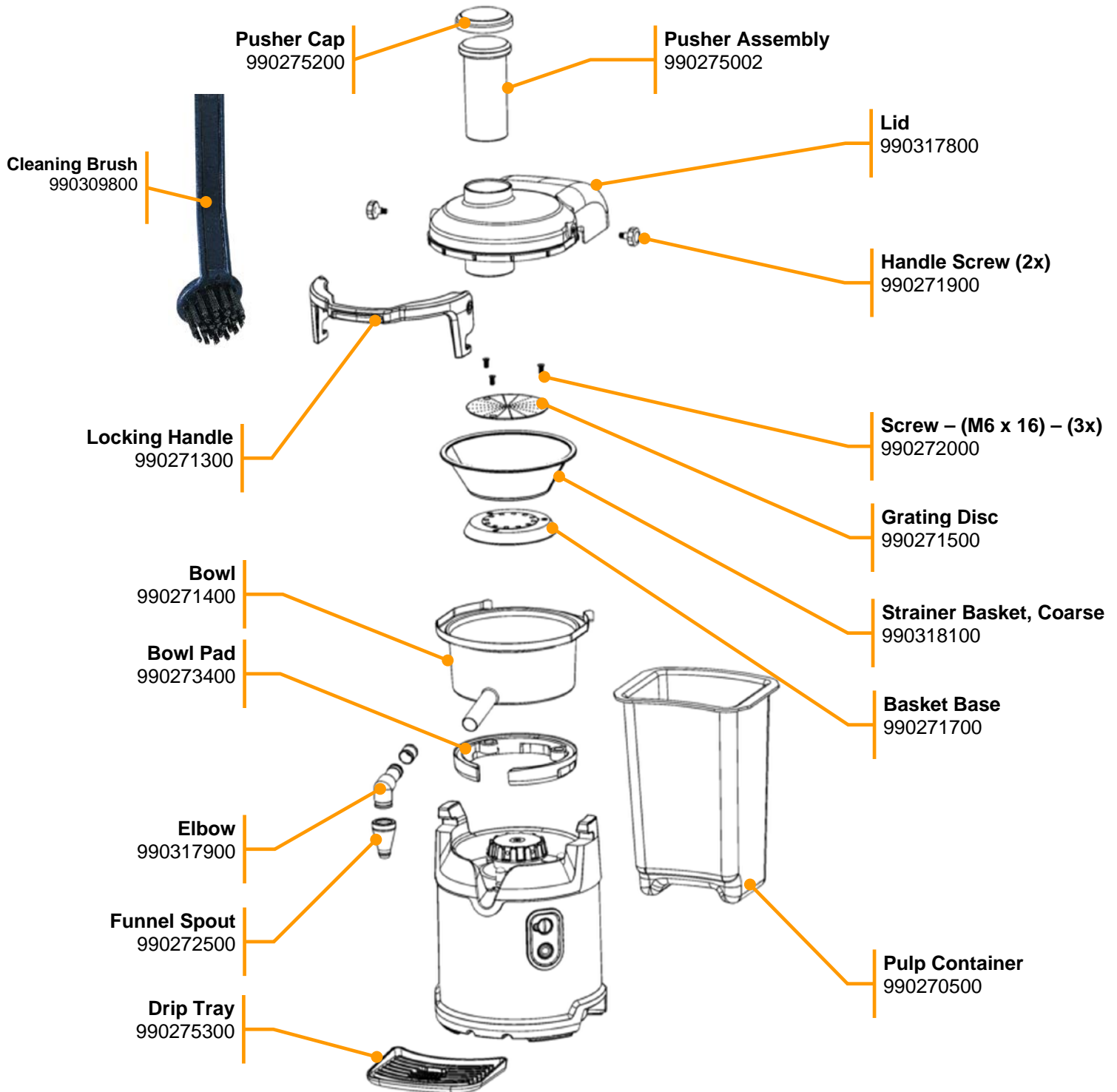

## Parts & Accessories Diagram

**PROPRIETARY RIGHTS NOTICE** This document and all information contained within it is the property of Hamilton Beach Brands, Inc. (HBB). It is confidential and proprietary and has been provided to you for a limited purpose. It must be returned or destroyed upon request. Disclosure, reproduction or use of this document and any information contained within it, in full or in part, for any purpose is forbidden without the prior written consent of HBB. No photographs may be taken of any article fabricated or assembled from this document without the prior written consent of HBB.

### Replacement Parts



 4421 Waterfront Drive Glen Allen, VA 23060	Revision	Production Release					Rev. Date:	
	Description:						12/22/2022	
	Request #:	DOC12844	Page:	1 of 19	Document #:	540102402	Rev:	A

## Parts & Accessories Diagram

**PROPRIETARY RIGHTS NOTICE** This document and all information contained within it is the property of Hamilton Beach Brands, Inc. (HBB). It is confidential and proprietary and has been provided to you for a limited purpose. It must be returned or destroyed upon request. Disclosure, reproduction or use of this document and any information contained within it, in full or in part, for any purpose is forbidden without the prior written consent of HBB. No photographs may be taken of any article fabricated or assembled from this document without the prior written consent of HBB.

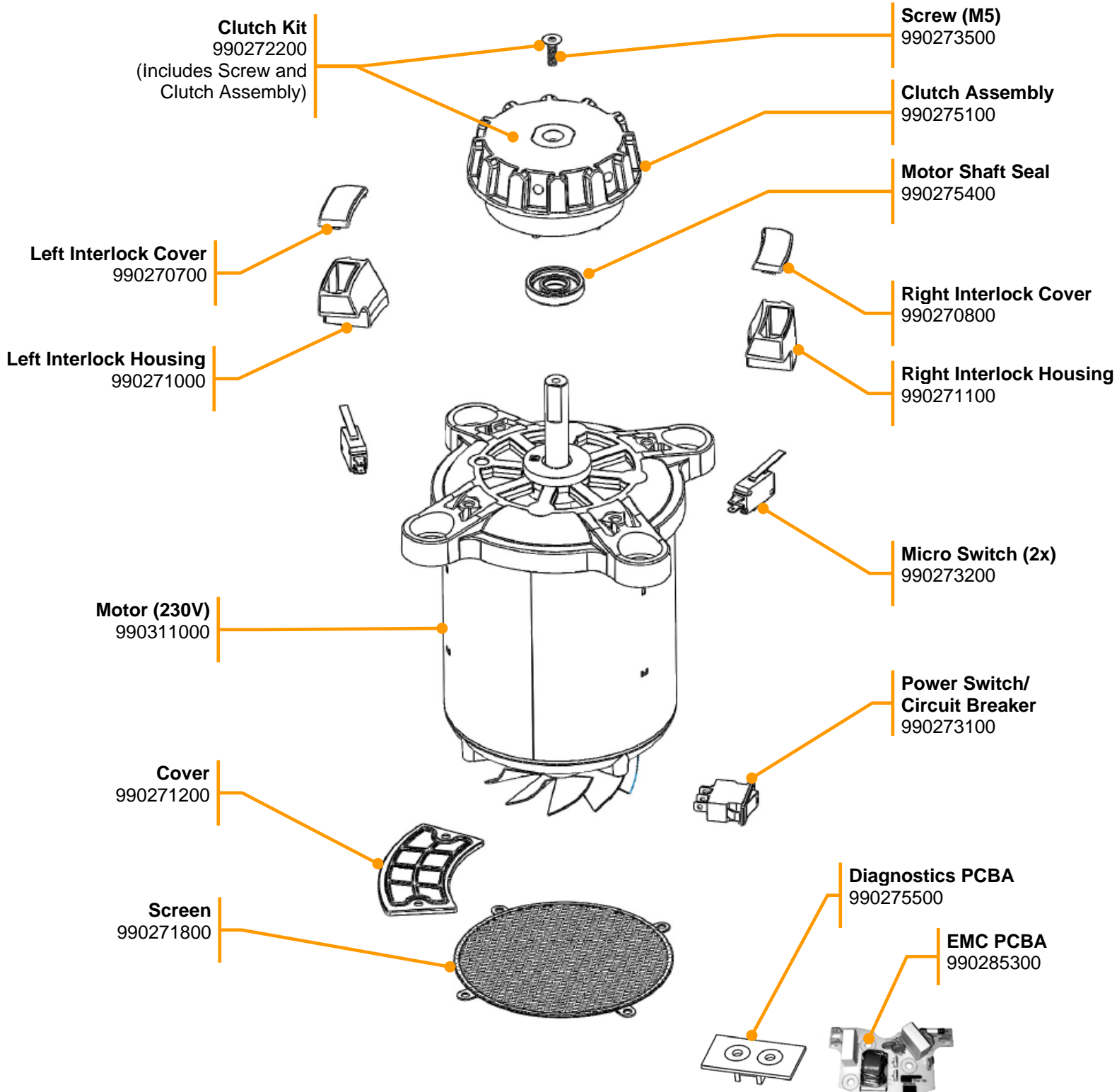



 4421 Waterfront Drive Glen Allen, VA 23060	Revision		Production Release					Rev. Date:	
	Description:							12/22/2022	
	Request #:		DOC12844	Page:	2 of 19	Document #:	540102402	Rev:	A

Parts & Accessories Diagram

**PROPRIETARY RIGHTS NOTICE** This document and all information contained within it is the property of Hamilton Beach Brands, Inc. (HBB). It is confidential and proprietary and has been provided to you for a limited purpose. It must be returned or destroyed upon request. Disclosure, reproduction or use of this document and any information contained within it, in full or in part, for any purpose is forbidden without the prior written consent of HBB. No photographs may be taken of any article fabricated or assembled from this document without the prior written consent of HBB.

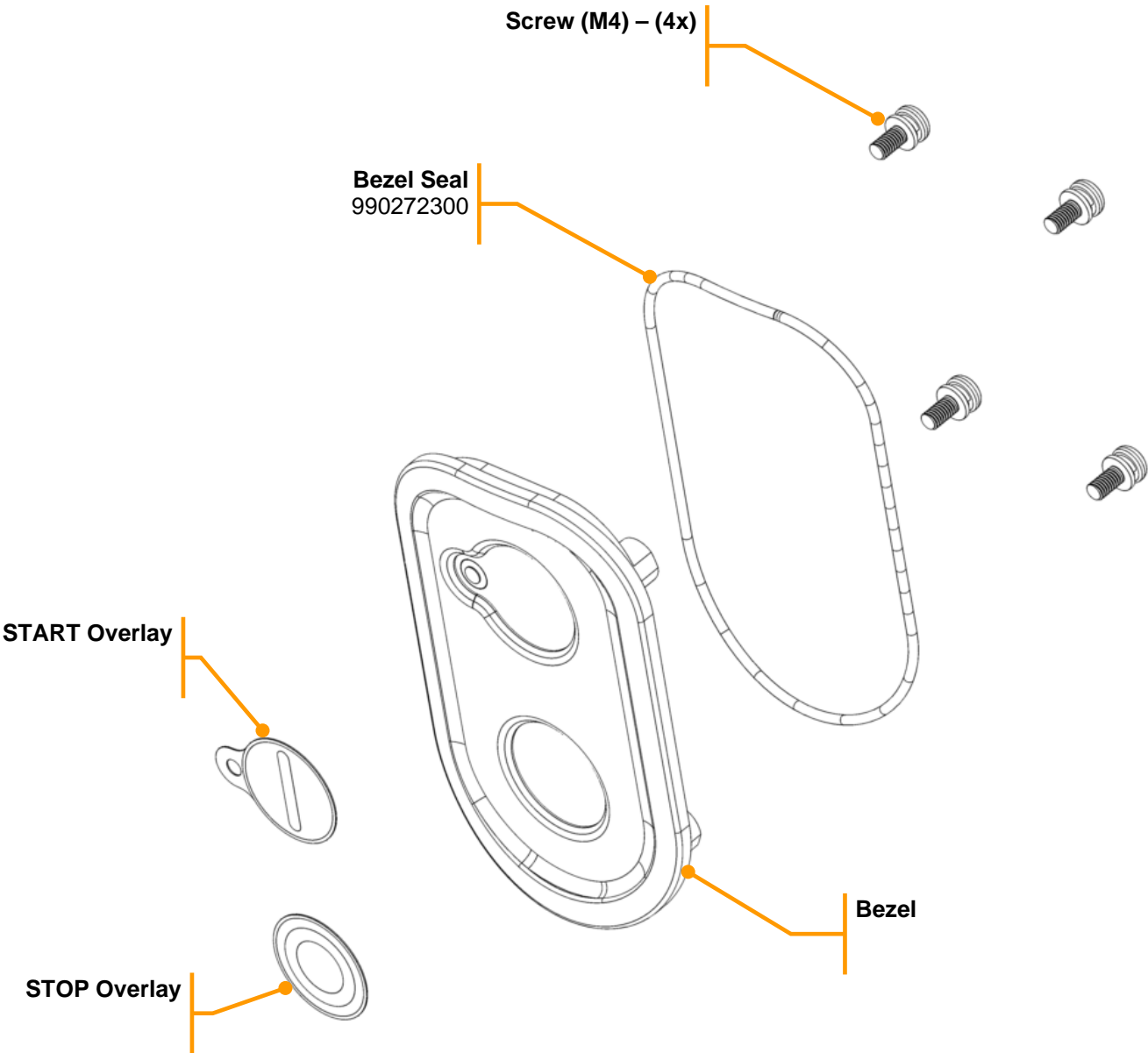
Bezel Service Kit, 990273700 – Includes all components as pictured below





 4421 Waterfront Drive Glen Allen, VA 23060	Revision	Production Release					Rev. Date:	
	Description:						12/22/2022	
	Request #:	DOC12844	Page:	3 of 19	Document #:	540102402	Rev:	A

Parts & Accessories Diagram

**PROPRIETARY RIGHTS NOTICE** This document and all information contained within it is the property of Hamilton Beach Brands, Inc. (HBB). It is confidential and proprietary and has been provided to you for a limited purpose. It must be returned or destroyed upon request. Disclosure, reproduction or use of this document and any information contained within it, in full or in part, for any purpose is forbidden without the prior written consent of HBB. No photographs may be taken of any article fabricated or assembled from this document without the prior written consent of HBB.

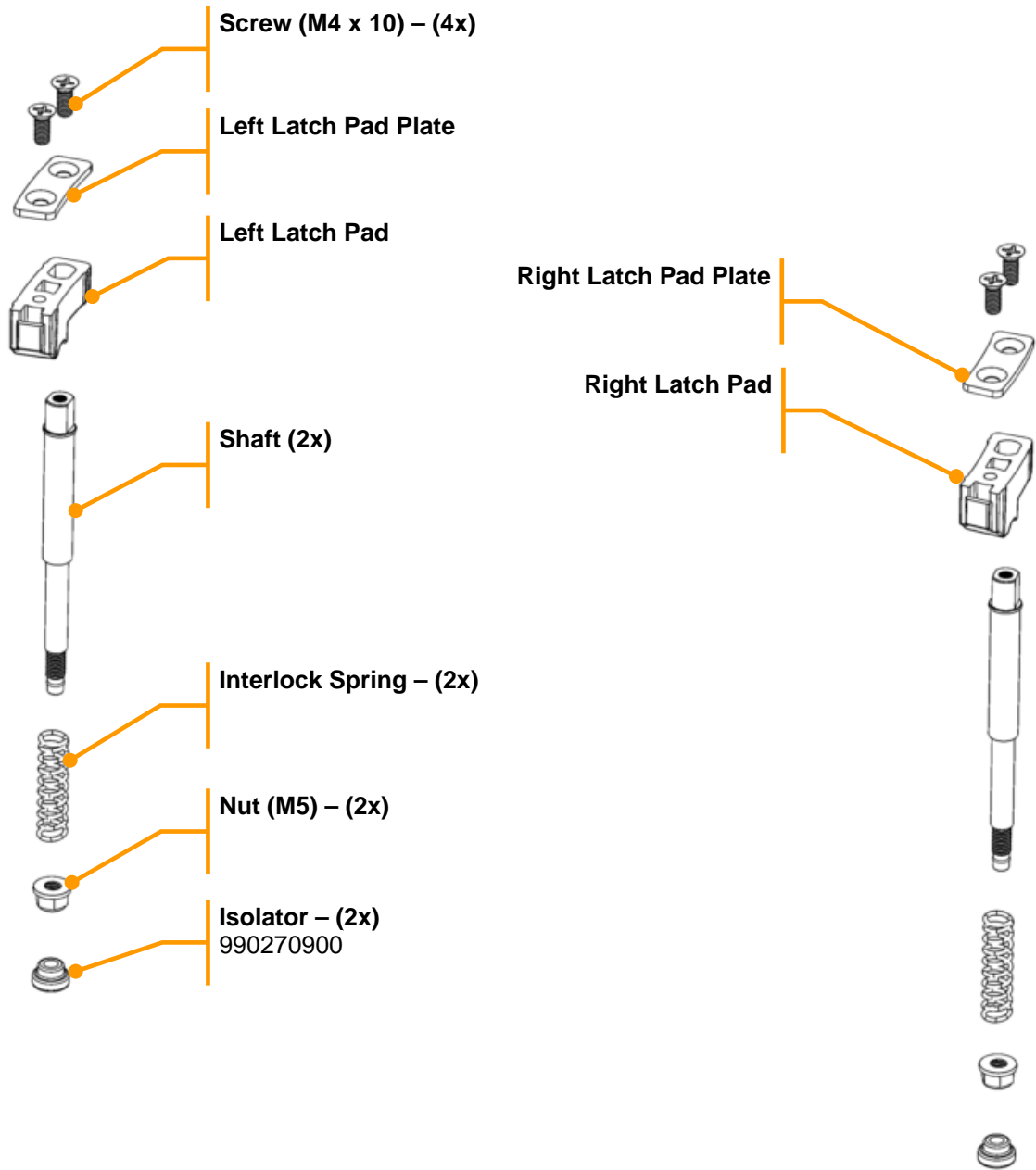
Latch Service Kit, 990273800 – Includes all components as pictured below





 4421 Waterfront Drive Glen Allen, VA 23060	Revision	Production Release					Rev. Date:	
	Description:						12/22/2022	
	Request #:	DOC12844	Page:	4 of 19	Document #:	540102402	Rev:	A

Parts & Accessories Diagram

**PROPRIETARY RIGHTS NOTICE** This document and all information contained within it is the property of Hamilton Beach Brands, Inc. (HBB). It is confidential and proprietary and has been provided to you for a limited purpose. It must be returned or destroyed upon request. Disclosure, reproduction or use of this document and any information contained within it, in full or in part, for any purpose is forbidden without the prior written consent of HBB. No photographs may be taken of any article fabricated or assembled from this document without the prior written consent of HBB.

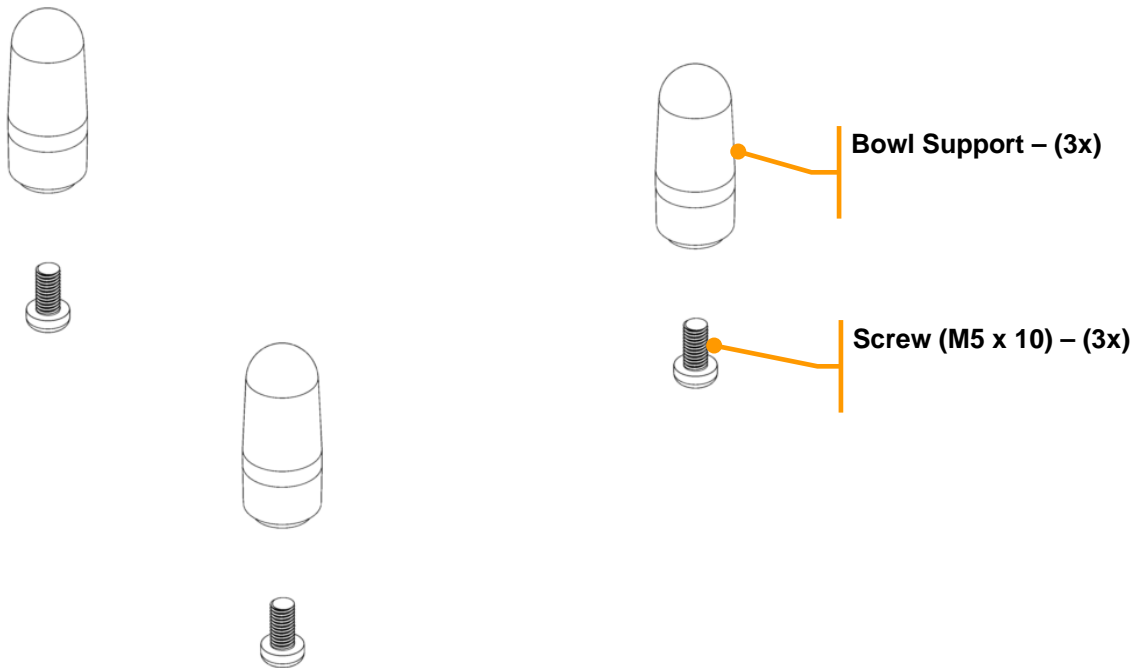
Bowl Support Service Kit, 990273900 – Includes all components as pictured below





 4421 Waterfront Drive Glen Allen, VA 23060	Revision	Production Release					Rev. Date:	
	Description:						12/22/2022	
	Request #:	DOC12844	Page:	5 of 19	Document #:	540102402	Rev:	A

Parts & Accessories Diagram

**PROPRIETARY RIGHTS NOTICE** This document and all information contained within it is the property of Hamilton Beach Brands, Inc. (HBB). It is confidential and proprietary and has been provided to you for a limited purpose. It must be returned or destroyed upon request. Disclosure, reproduction or use of this document and any information contained within it, in full or in part, for any purpose is forbidden without the prior written consent of HBB. No photographs may be taken of any article fabricated or assembled from this document without the prior written consent of HBB.

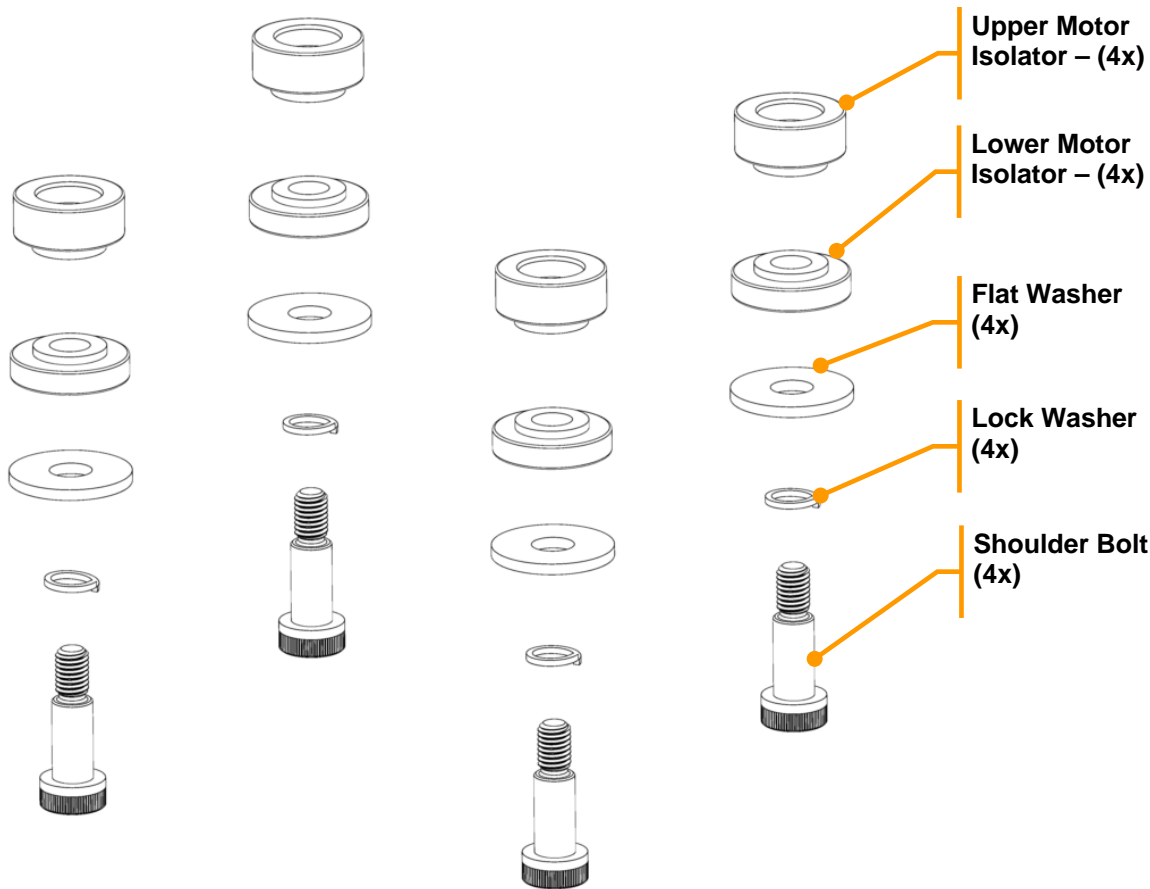
Motor Hardware Kit, 990274000 – Includes all components as pictured below





 4421 Waterfront Drive Glen Allen, VA 23060	Revision	Production Release					Rev. Date:	
	Description:						12/22/2022	
	Request #:	DOC12844	Page:	6 of 19	Document #:	540102402	Rev:	A

Parts & Accessories Diagram

**PROPRIETARY RIGHTS NOTICE** This document and all information contained within it is the property of Hamilton Beach Brands, Inc. (HBB). It is confidential and proprietary and has been provided to you for a limited purpose. It must be returned or destroyed upon request. Disclosure, reproduction or use of this document and any information contained within it, in full or in part, for any purpose is forbidden without the prior written consent of HBB. No photographs may be taken of any article fabricated or assembled from this document without the prior written consent of HBB.

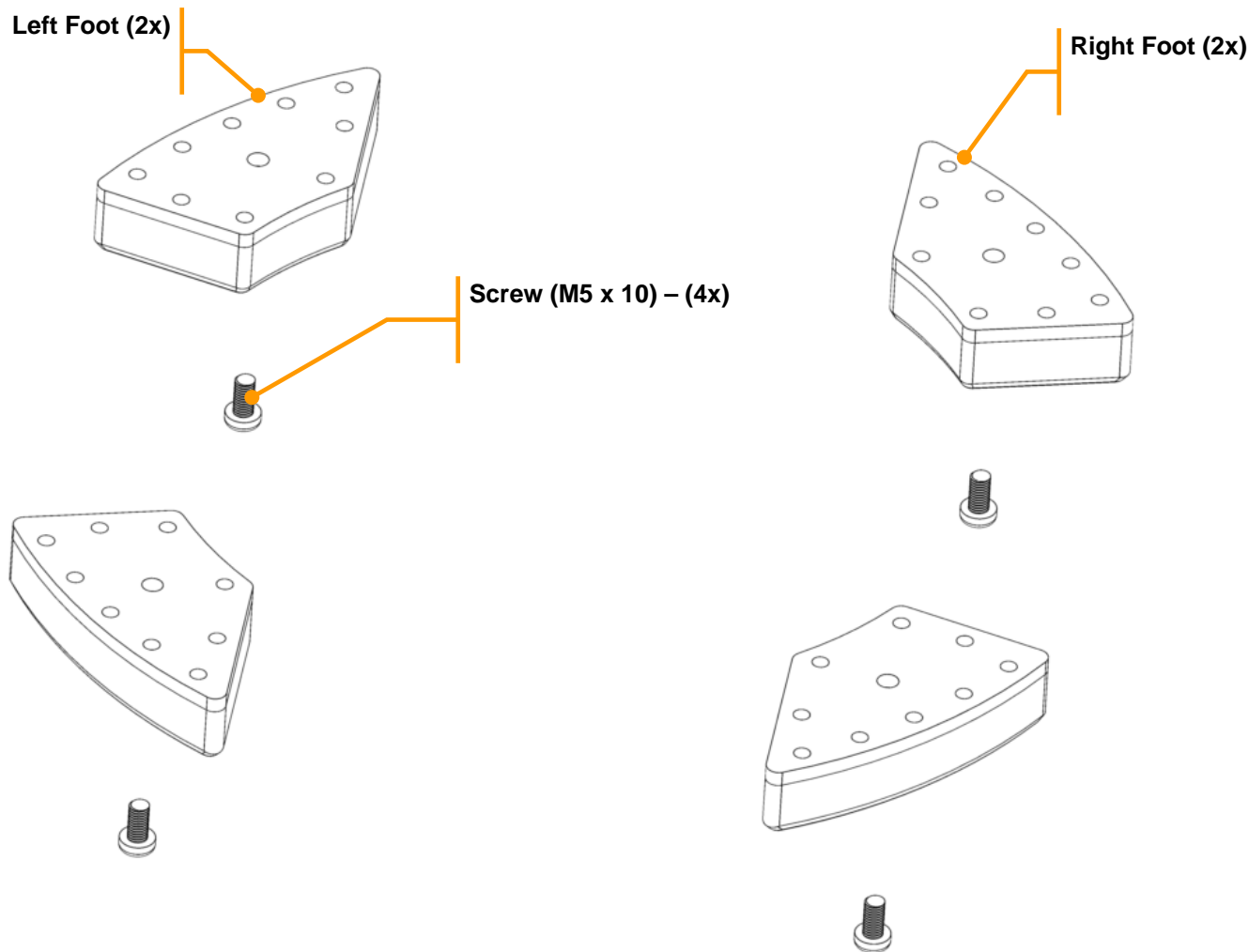
Rubber Foot Kit, 990274101 – Includes all components as pictured below





 4421 Waterfront Drive Glen Allen, VA 23060	Revision	Production Release					Rev. Date:	
	Description:						12/22/2022	
	Request #:	DOC12844	Page:	7 of 19	Document #:	540102402	Rev:	A

Parts & Accessories Diagram

**PROPRIETARY RIGHTS NOTICE** This document and all information contained within it is the property of Hamilton Beach Brands, Inc. (HBB). It is confidential and proprietary and has been provided to you for a limited purpose. It must be returned or destroyed upon request. Disclosure, reproduction or use of this document and any information contained within it, in full or in part, for any purpose is forbidden without the prior written consent of HBB. No photographs may be taken of any article fabricated or assembled from this document without the prior written consent of HBB.

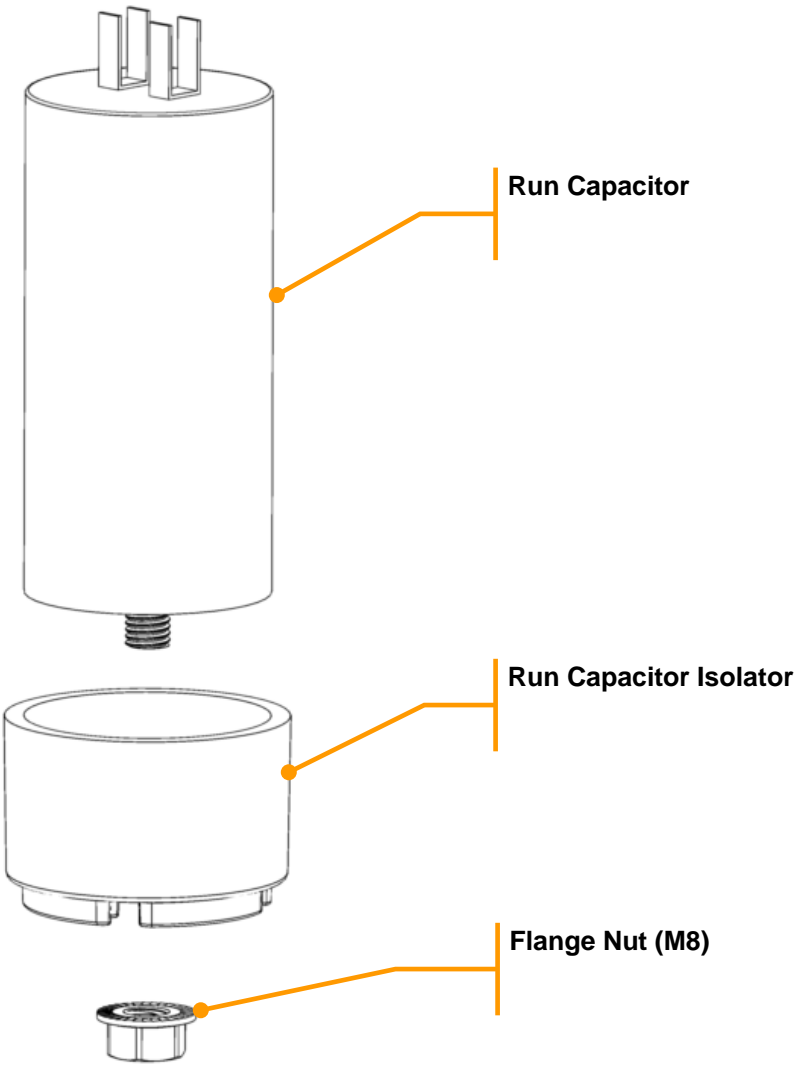
Run Capacitor Kit, 990274201 – Includes all components as pictured below



 4421 Waterfront Drive Glen Allen, VA 23060	Revision	Production Release					Rev. Date:	
	Description:						12/22/2022	
	Request #:	DOC12844	Page:	8 of 19	Document #:	540102402	Rev:	A



Parts & Accessories Diagram

**PROPRIETARY RIGHTS NOTICE** This document and all information contained within it is the property of Hamilton Beach Brands, Inc. (HBB). It is confidential and proprietary and has been provided to you for a limited purpose. It must be returned or destroyed upon request. Disclosure, reproduction or use of this document and any information contained within it, in full or in part, for any purpose is forbidden without the prior written consent of HBB. No photographs may be taken of any article fabricated or assembled from this document without the prior written consent of HBB.

Start Capacitor Kit, 990274301 – Includes all components as pictured below

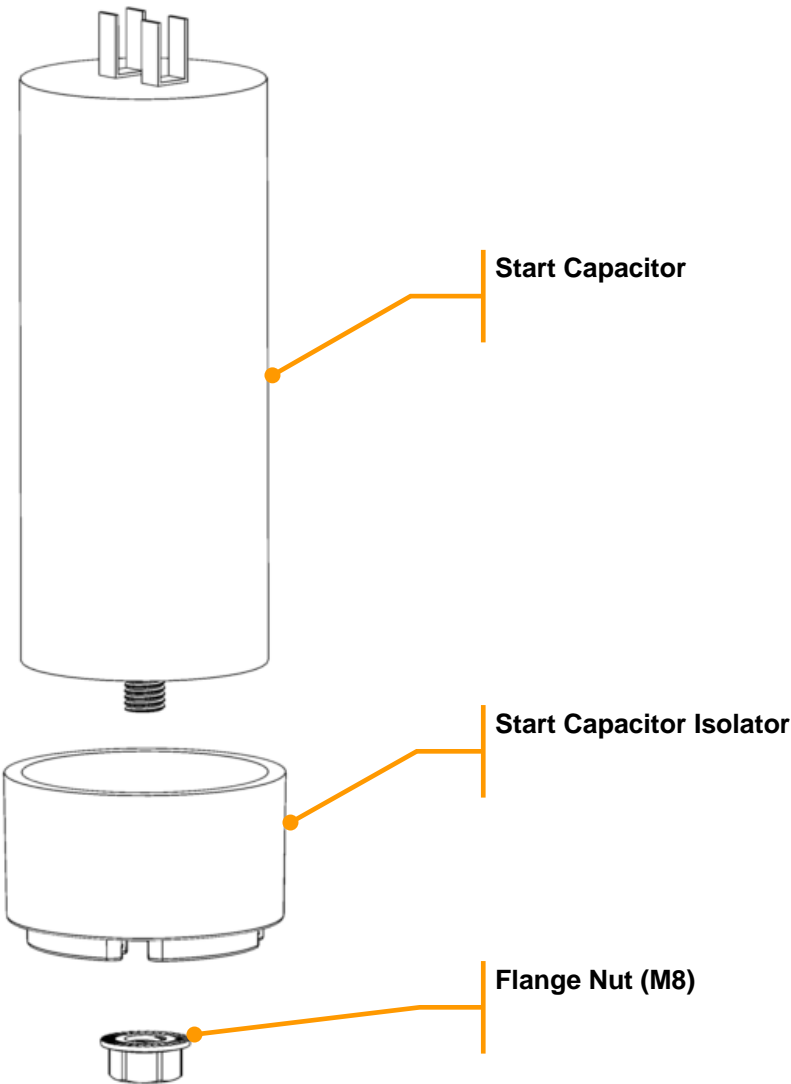



 4421 Waterfront Drive Glen Allen, VA 23060	Revision	Production Release					Rev. Date:	
	Description:						12/22/2022	
	Request #:	DOC12844	Page:	9 of 19	Document #:	540102402	Rev:	A

Parts & Accessories Diagram

**PROPRIETARY RIGHTS NOTICE** This document and all information contained within it is the property of Hamilton Beach Brands, Inc. (HBB). It is confidential and proprietary and has been provided to you for a limited purpose. It must be returned or destroyed upon request. Disclosure, reproduction or use of this document and any information contained within it, in full or in part, for any purpose is forbidden without the prior written consent of HBB. No photographs may be taken of any article fabricated or assembled from this document without the prior written consent of HBB.

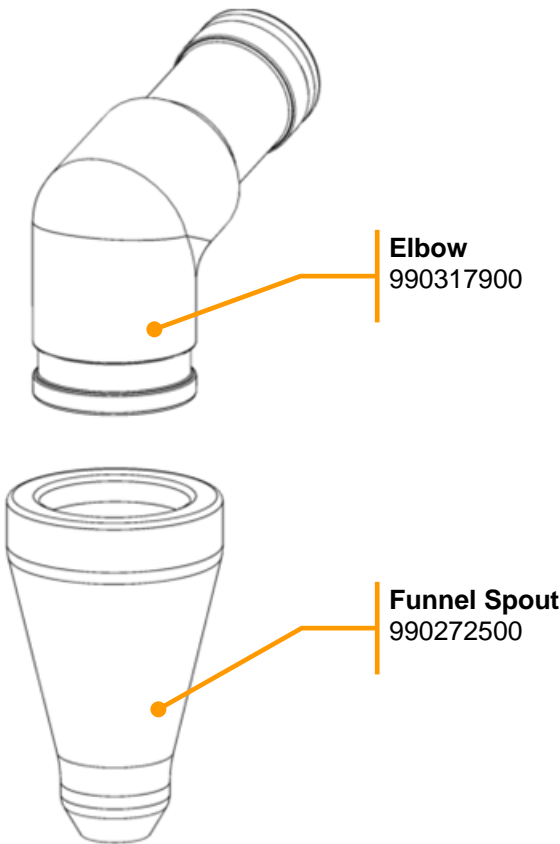
Spout Kit, 990318000 – Includes all components as pictured below



 4421 Waterfront Drive Glen Allen, VA 23060	Revision	Production Release					Rev. Date:	
	Description:						12/22/2022	
	Request #:	DOC12844	Page:	10 of 19	Document #:	540102402	Rev:	A

Parts & Accessories Diagram

**PROPRIETARY RIGHTS NOTICE** This document and all information contained within it is the property of Hamilton Beach Brands, Inc. (HBB). It is confidential and proprietary and has been provided to you for a limited purpose. It must be returned or destroyed upon request. Disclosure, reproduction or use of this document and any information contained within it, in full or in part, for any purpose is forbidden without the prior written consent of HBB. No photographs may be taken of any article fabricated or assembled from this document without the prior written consent of HBB.

Start/Stop PCBA Kit, 990309000 – Includes all components as pictured below

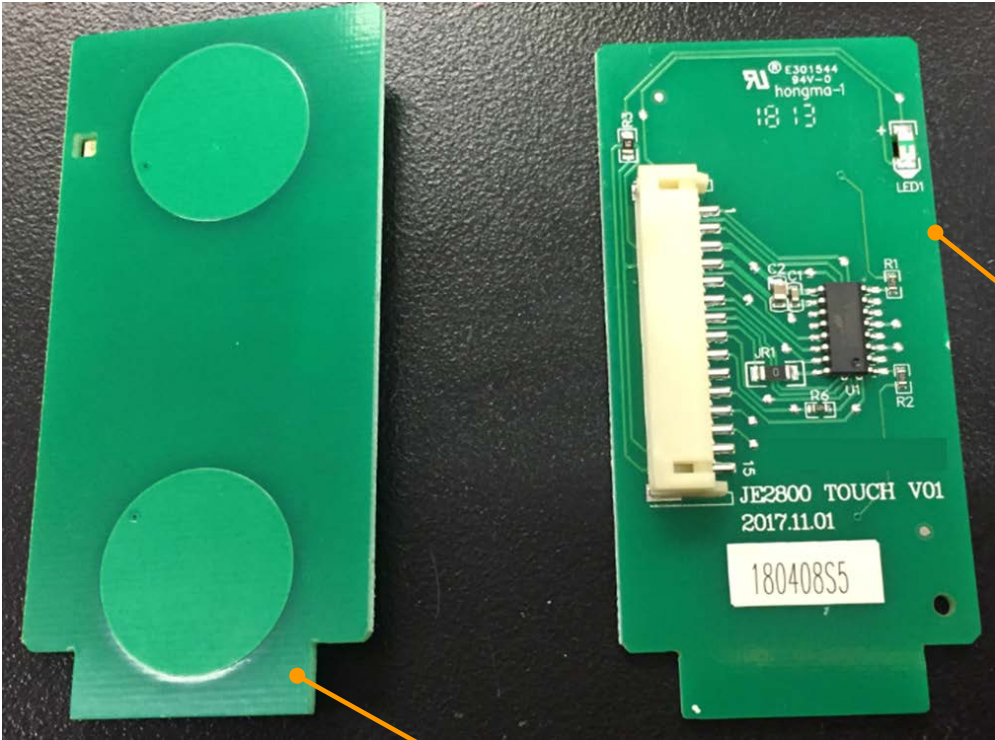

Start/Stop PCBA  
230V version w/  
15pin Connector  
230 V version

Start/Stop PCBA  
Opposite side view

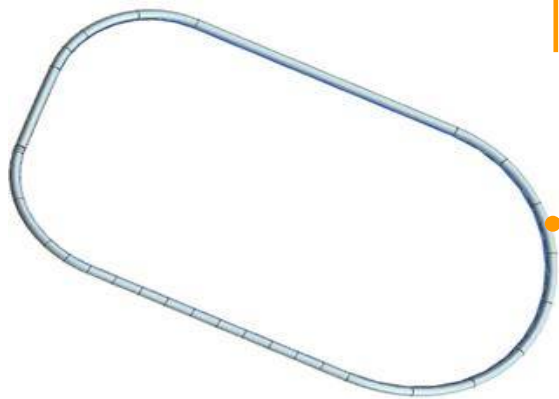

Bezel Seal



Screw (M4)  
(Qty. 4)

 Hamilton Beach 4421 Waterfront Drive Glen Allen, VA 23060	Revision	Production Release					Rev. Date:	
	Description:						12/22/2022	
	Request #:	DOC12844	Page:	11 of 19	Document #:	540102402	Rev:	A

Parts & Accessories Diagram

**PROPRIETARY RIGHTS NOTICE** This document and all information contained within it is the property of Hamilton Beach Brands, Inc. (HBB). It is confidential and proprietary and has been provided to you for a limited purpose. It must be returned or destroyed upon request. Disclosure, reproduction or use of this document and any information contained within it, in full or in part, for any purpose is forbidden without the prior written consent of HBB. No photographs may be taken of any article fabricated or assembled from this document without the prior written consent of HBB.

Single Relay (Brake) Assembly – 990374200

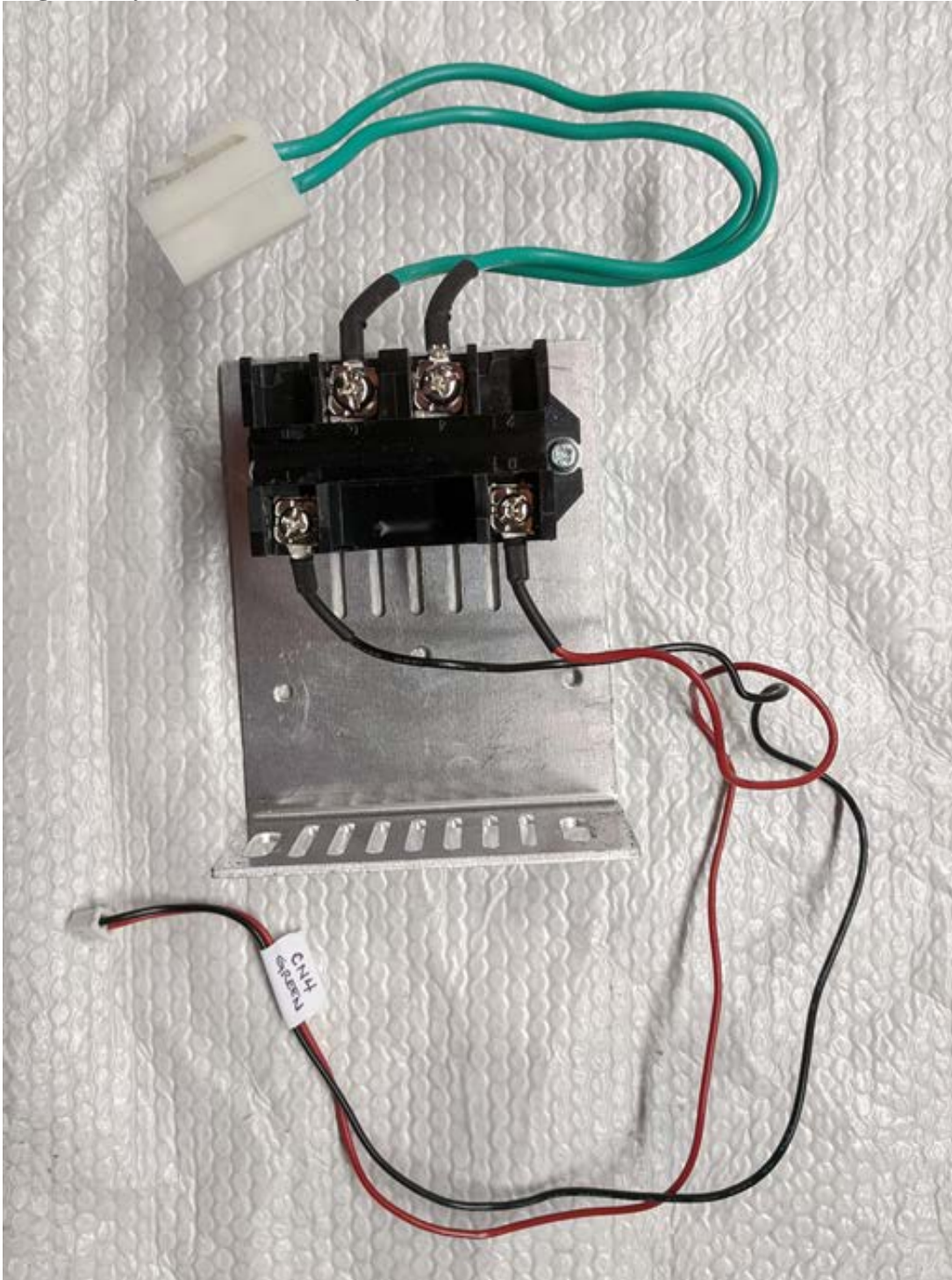

 4421 Waterfront Drive Glen Allen, VA 23060	Revision	Production Release					Rev. Date:	
	Description:						12/22/2022	
	Request #:	DOC12844	Page:	12 of 19	Document #:	540102402	Rev:	A



Parts & Accessories Diagram

**PROPRIETARY RIGHTS NOTICE** This document and all information contained within it is the property of Hamilton Beach Brands, Inc. (HBB). It is confidential and proprietary and has been provided to you for a limited purpose. It must be returned or destroyed upon request. Disclosure, reproduction or use of this document and any information contained within it, in full or in part, for any purpose is forbidden without the prior written consent of HBB. No photographs may be taken of any article fabricated or assembled from this document without the prior written consent of HBB.

Dual Relay (Motor Starting / Running) Assembly – 990374300

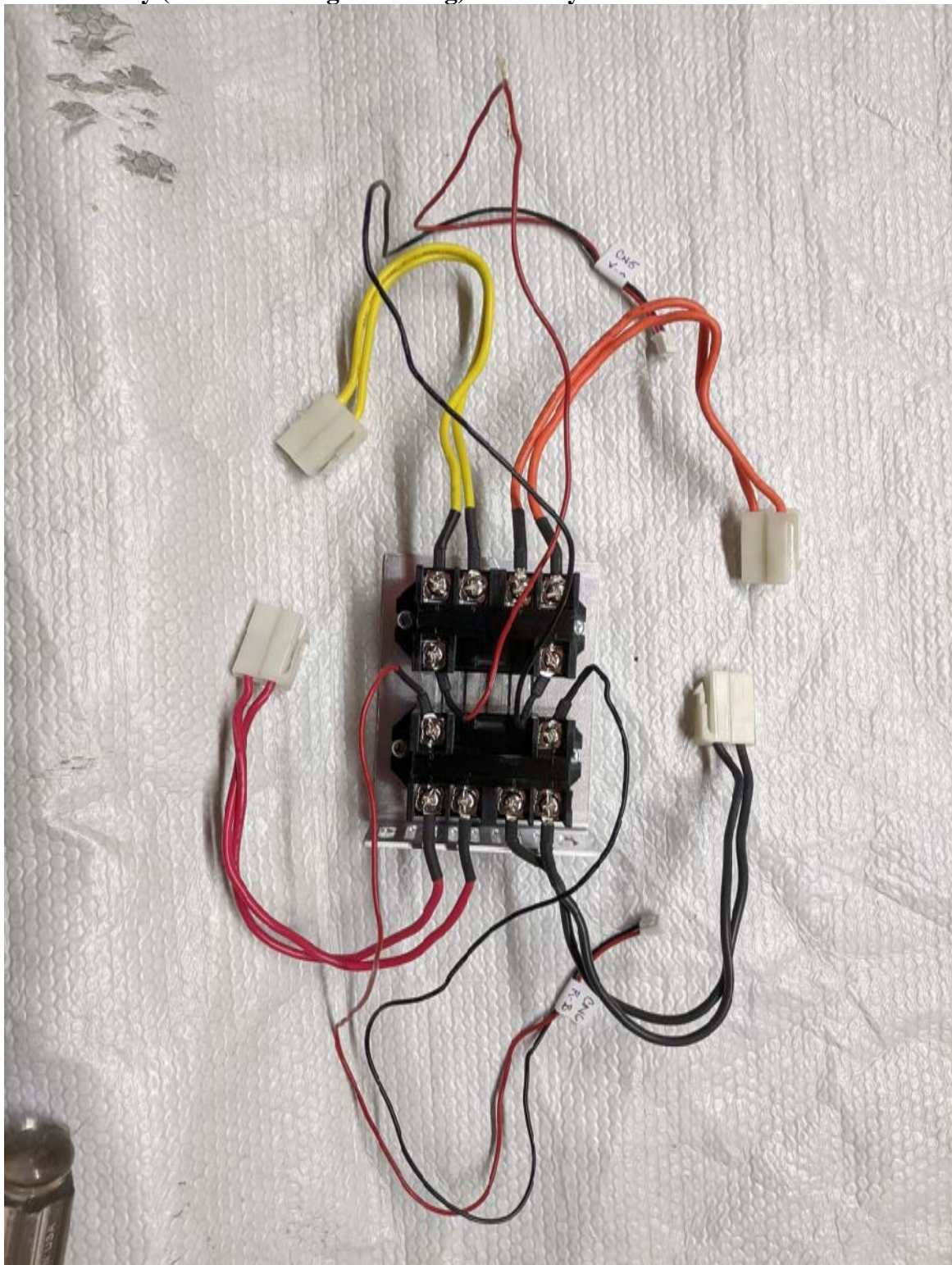



 4421 Waterfront Drive Glen Allen, VA 23060	Revision	Production Release					Rev. Date:	
	Description:						12/22/2022	
	Request #:	DOC12844	Page:	13 of 19	Document #:	540102402	Rev:	A

Parts & Accessories Diagram

**PROPRIETARY RIGHTS NOTICE** This document and all information contained within it is the property of Hamilton Beach Brands, Inc. (HBB). It is confidential and proprietary and has been provided to you for a limited purpose. It must be returned or destroyed upon request. Disclosure, reproduction or use of this document and any information contained within it, in full or in part, for any purpose is forbidden without the prior written consent of HBB. No photographs may be taken of any article fabricated or assembled from this document without the prior written consent of HBB.

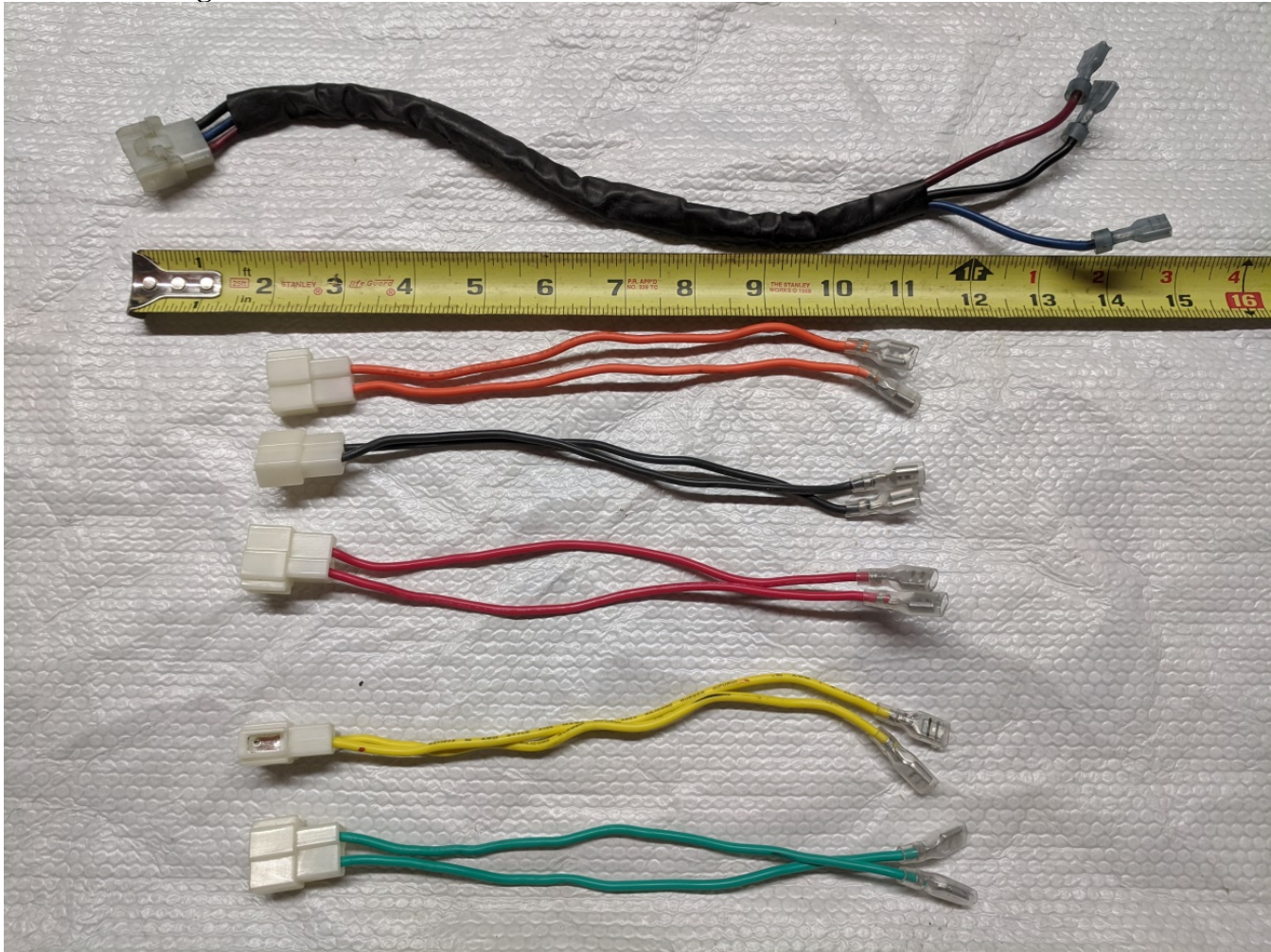
Wiring Harness – 990374400



 4421 Waterfront Drive Glen Allen, VA 23060	Revision	Production Release					Rev. Date:	
	Description:						12/22/2022	
	Request #:	DOC12844	Page:	14 of 19	Document #:	540102402	Rev:	A



Parts & Accessories Diagram

**PROPRIETARY RIGHTS NOTICE** This document and all information contained within it is the property of Hamilton Beach Brands, Inc. (HBB). It is confidential and proprietary and has been provided to you for a limited purpose. It must be returned or destroyed upon request. Disclosure, reproduction or use of this document and any information contained within it, in full or in part, for any purpose is forbidden without the prior written consent of HBB. No photographs may be taken of any article fabricated or assembled from this document without the prior written consent of HBB.

**Ribbon Harness, 230 V – 990374600 (ribbon assembly provided with 3 connectors – (1) 15pin, (1) 10pin & (1) 5pin)**

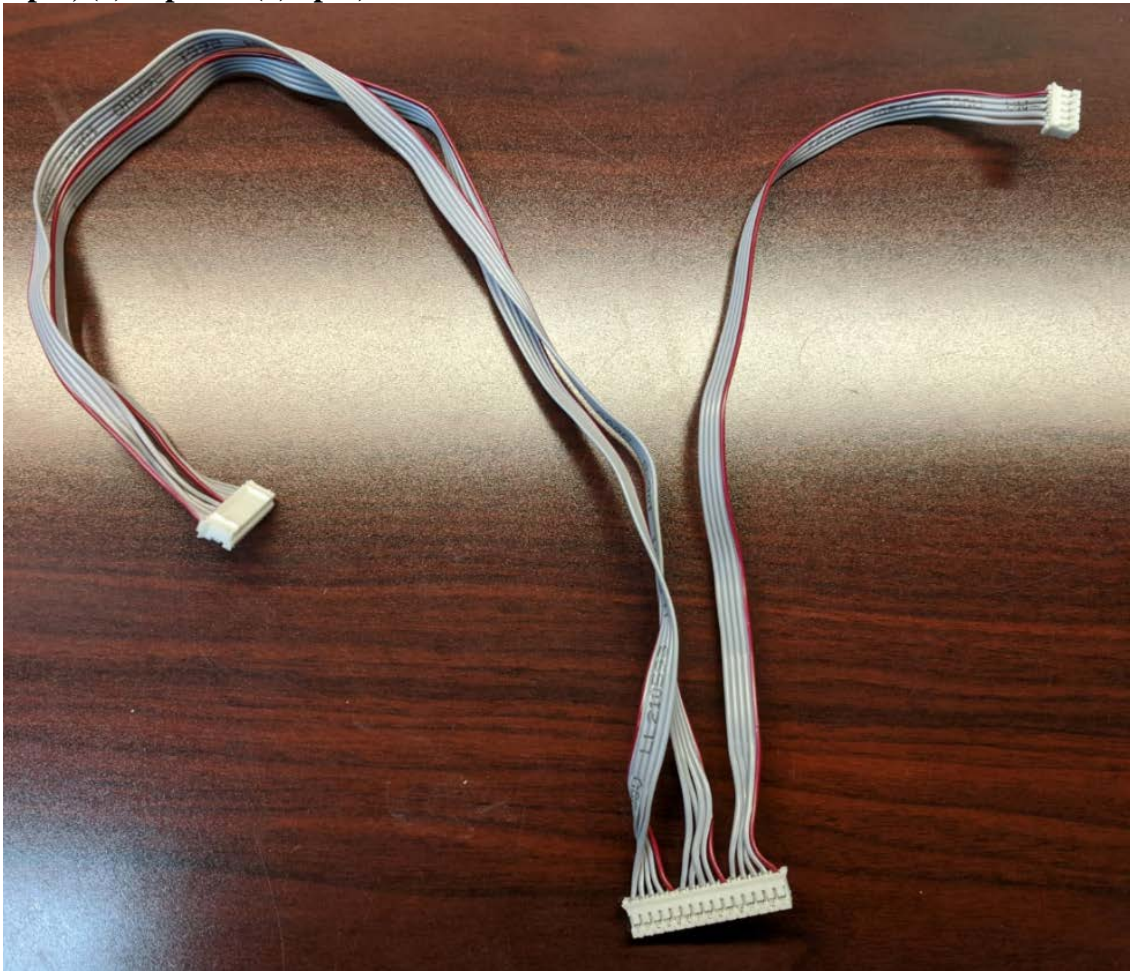



 4421 Waterfront Drive Glen Allen, VA 23060	Revision	Production Release					Rev. Date:	
	Description:						12/22/2022	
	Request #:	DOC12844	Page:	15 of 19	Document #:	540102402	Rev:	A

## Parts & Accessories Diagram

**PROPRIETARY RIGHTS NOTICE** This document and all information contained within it is the property of Hamilton Beach Brands, Inc. (HBB). It is confidential and proprietary and has been provided to you for a limited purpose. It must be returned or destroyed upon request. Disclosure, reproduction or use of this document and any information contained within it, in full or in part, for any purpose is forbidden without the prior written consent of HBB. No photographs may be taken of any article fabricated or assembled from this document without the prior written consent of HBB.

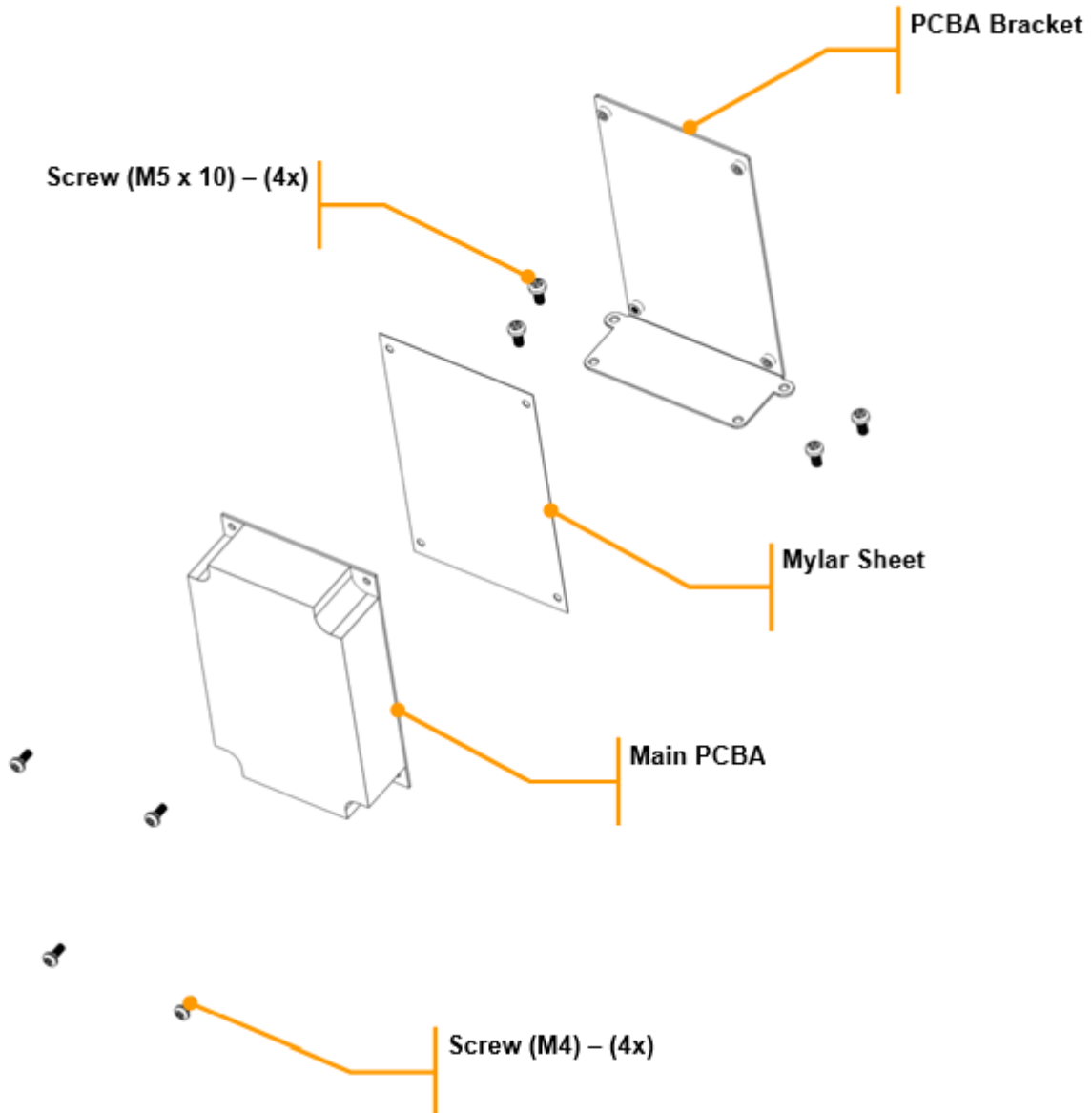
### Main PCB Assembly (230 V) – 990374100



 4421 Waterfront Drive Glen Allen, VA 23060	Revision	Production Release					Rev. Date:	
	Description:						12/22/2022	
	Request #:	DOC12844	Page:	16 of 19	Document #:	540102402	Rev:	A



## Parts & Accessories Diagram

**PROPRIETARY RIGHTS NOTICE** This document and all information contained within it is the property of Hamilton Beach Brands, Inc. (HBB). It is confidential and proprietary and has been provided to you for a limited purpose. It must be returned or destroyed upon request. Disclosure, reproduction or use of this document and any information contained within it, in full or in part, for any purpose is forbidden without the prior written consent of HBB. No photographs may be taken of any article fabricated or assembled from this document without the prior written consent of HBB.

### Cord Kit (230V CN), 990274603 – Includes all components as pictured below & strain relief grommet

**Power Cord (230 V, CN)**  
990309900

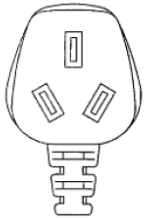
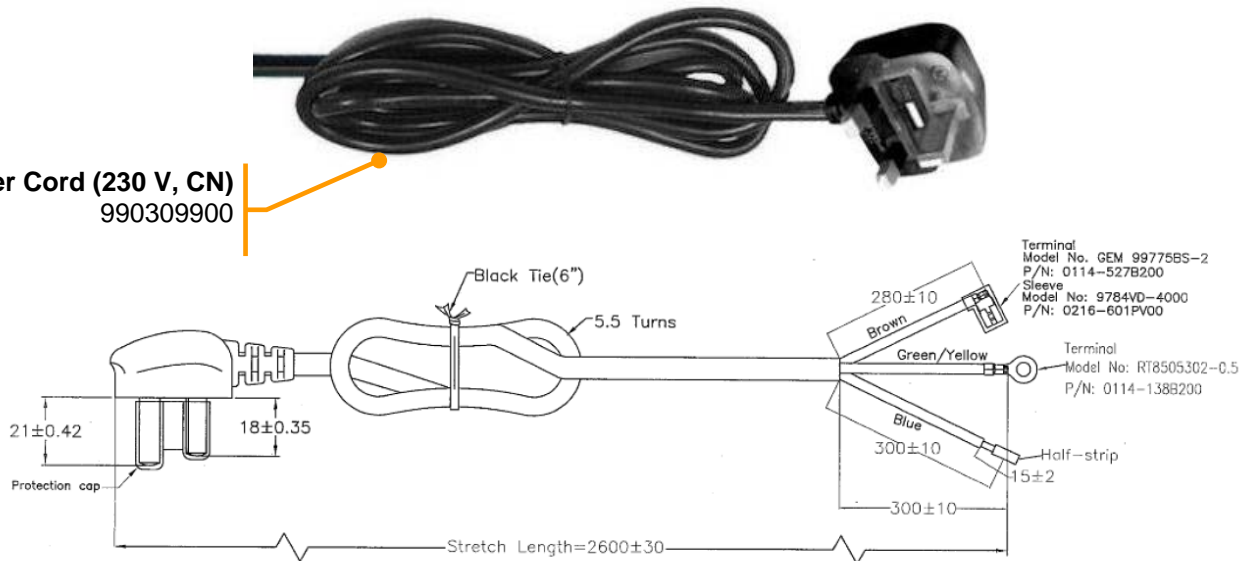

**Note:**

- Cable: 60245 IEC 57(YZW) 3G1mm<sup>2</sup> (ø0.15Asx56), Marking: SUN FAI H05RN-F 60245 IEC 57(YZW) 3G1mm<sup>2</sup> 300/500V IEC60245 CABO FLEXIVEL ▲ CCC A063758 R21004 RoHS SU01002-16001 <VDE> LF
- Plug: Cat. No. SF-923. Rated 10A 250V. CCC approved.
- Color: Black
- For Client M001. (P/N: 16-0000-01103-CCC)

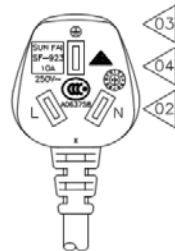
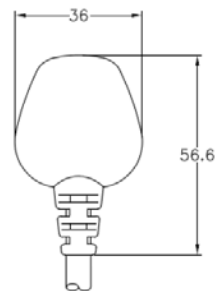
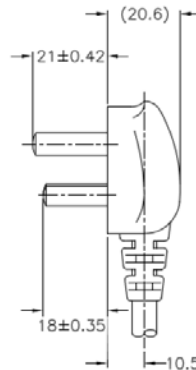
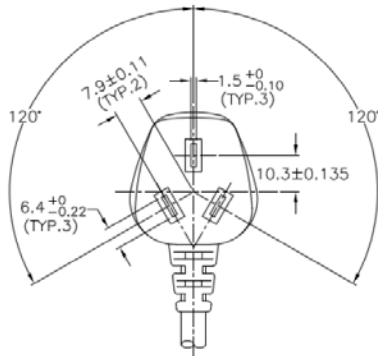

**Note:**

- According to standard GB1002.
- Rated: 10A 250V.
- Approved: CCC

<b>Hamilton Beach</b> 4421 Waterfront Drive Glen Allen, VA 23060	Revision	Production Release				Rev. Date:	
	Description:					12/22/2022	
	Request #:	DOC12844	Page:	17 of 19	Document #:	540102402	Rev: A

Parts & Accessories Diagram

**PROPRIETARY RIGHTS NOTICE** This document and all information contained within it is the property of Hamilton Beach Brands, Inc. (HBB). It is confidential and proprietary and has been provided to you for a limited purpose. It must be returned or destroyed upon request. Disclosure, reproduction or use of this document and any information contained within it, in full or in part, for any purpose is forbidden without the prior written consent of HBB. No photographs may be taken of any article fabricated or assembled from this document without the prior written consent of HBB.



**Strain Relief Grommet**  
990273600

Accessories

**Under The Counter Pulp Chute, UTC960 – Includes all components as pictured below**

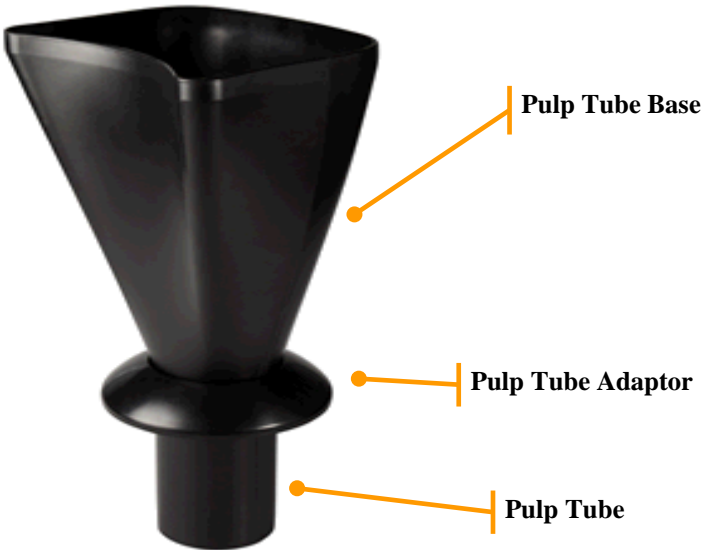

 4421 Waterfront Drive Glen Allen, VA 23060	Revision	Production Release					Rev. Date:	
	Description:						12/22/2022	
	Request #:	DOC12844	Page:	18 of 19	Document #:	540102402	Rev:	A

Parts & Accessories Diagram

**PROPRIETARY RIGHTS NOTICE** This document and all information contained within it is the property of Hamilton Beach Brands, Inc. (HBB). It is confidential and proprietary and has been provided to you for a limited purpose. It must be returned or destroyed upon request. Disclosure, reproduction or use of this document and any information contained within it, in full or in part, for any purpose is forbidden without the prior written consent of HBB. No photographs may be taken of any article fabricated or assembled from this document without the prior written consent of HBB.

Strainer Baskets:  
SB960 for Normal “Wet” Foods

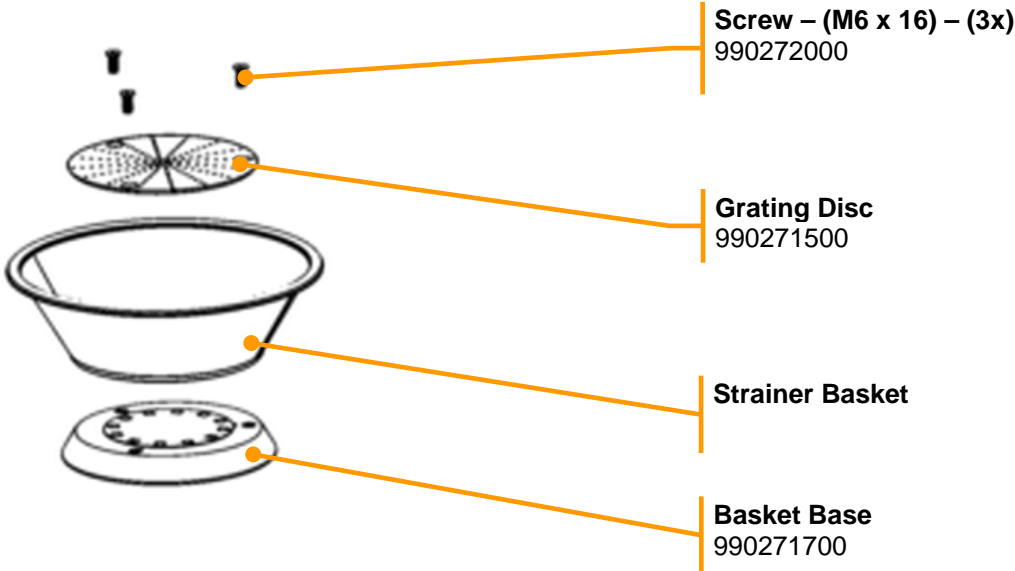

SB961 for Green Leafy Vegetables (i.e. Kale, Spinach, etc.)

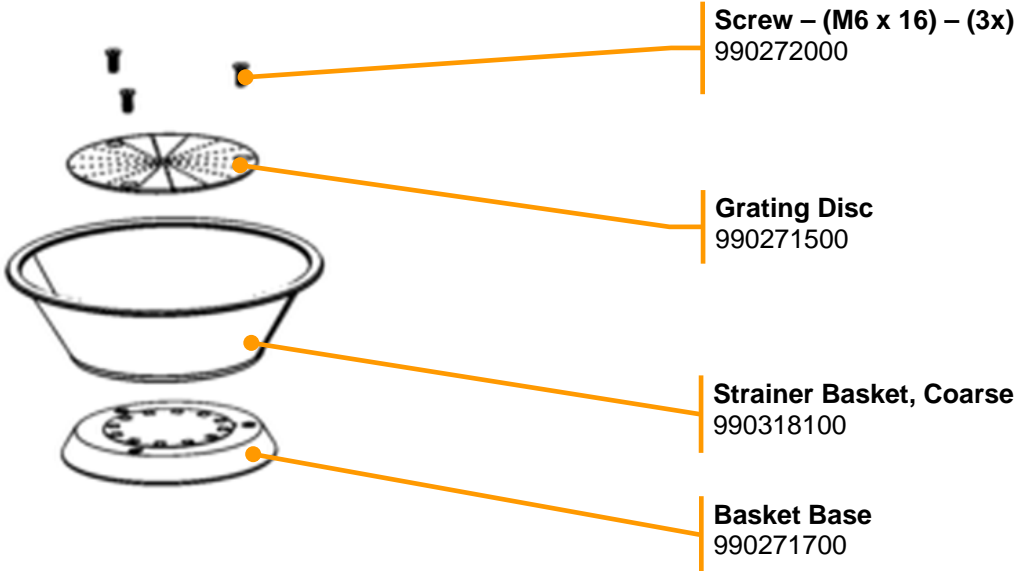

 4421 Waterfront Drive Glen Allen, VA 23060	Revision Description:		Production Release					Rev. Date:	
								12/22/2022	
	Request #:	DOC12844	Page:	19 of 19	Document #:	540102402	Rev:	A	