



FLAV-R-SAVOR®

Heat & Humidity Merchandising Cabinets

FSD & FSDT Series

FSD-1

FSDT-1

FSD-1X

FSDT-1X

FSD-2

FSDT-2

FSD-2X

FSDT-2X

REPLACEMENT PARTS LIST

HATCO FLAV-R-SAVOR® MERCHANDISING CABINETS FSD & FSDT SERIES

Model Designation	
FSDT-XX	
F	Flav-R
S	Savor
D	Display
T	Tall
X	Quantity of Doors
X	No Rotating Rack Motor

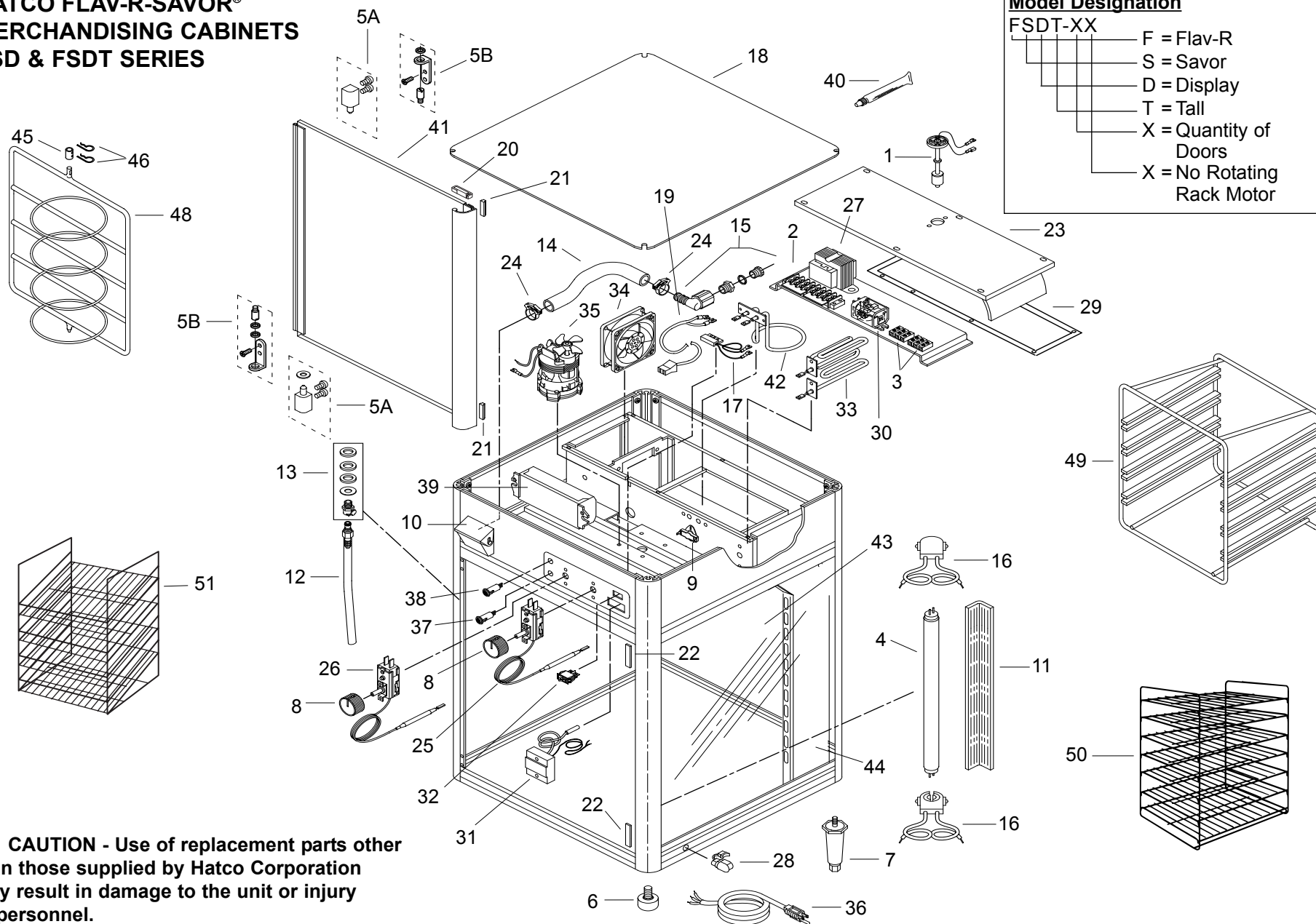

PARTS COMMON TO ALL FSD & FSDT MODELS

ITEM	DESCRIPTION	PART NO.	QTY.	ITEM	DESCRIPTION	PART NO.	QTY.
1	Float Switch	R02.01.029.00	1	14	Hose, Reservoir	03.40.051.00	2 ft.
2	Terminal Block, 8-Pole	02.15.012.00	1	15	Connector, Hose	R03.40.052.00	1
3	Terminal Block, 3-Pole	02.15.028.00	2	16	Light Socket	02.30.073.00	4
4	Display Light, 15 Watt	02.30.074.00	2	17	Switch, Proximity	02.19.084.00	1-2†
5A	Hinges-Door with Hardware "A" Style	R00.01.0115.00	1-2†	18	Cover, Top	R04.17.622.00	1
5B	Hinges-Door with Hardware "B" Style	R00.01.0121.00	1-2†	19	Power Cord, Blower	02.12.001A.00	1
6	Foot, Rubber	05.30.044.00	4	20	Magnet, Proximity Switch	R02.19.084A.00	1-2†
7	Leg, 4" (10 cm), Plastic (optional)	05.30.007.00	4	21	Magnet, Door with Adhesive	R05.30.076.00	1-2†
8	Knob, Control	05.30.047.00	2	22	Striker Plate, Door	04.17.649.00	2-4†
9	Hi-Limit Disk	R02.16.118.00	1	23	Cover, Air Chamber	04.17.623.00	1
10	Fill Cup with Cover	R05.30.050.00	1	24	Hose Clamps	05.04.354.00	2
11	Lens Cover, Light	02.30.076.00	2	25	Temperature Control	02.16.039.00	1
12	Plastic Drain Tube Assembly	R03.40.054.00	1	26	Humidity Control	02.16.039.00	1
13	Ceiling Drain Assembly	R03.40.055.00	1	27	Transformer, Step Down	02.17.040.00	1
				28	Strain Relief	02.20.206.00	1
				29	Air Chamber Gasket	05.06.028.00	5 ft.

† Quantity required depends on quantity of doors.

PARTS SPECIFIC TO MODEL FSD-1

ITEM	DESCRIPTION	120V 60 Hz	120V Canada	220V 50 Hz/60 Hz	240V 50 Hz/60 Hz	220-230V CE 50 Hz/60 Hz	230-240V CE 50 Hz/60 Hz
30	Control Relay	02.01.028.00	02.01.028.00	02.01.043.00	02.01.043.00	02.01.043.00	02.01.043.00
31	Temperature Display	02.16.057.00	02.16.057.00	02.16.058.00	02.16.058.00	02.16.058.00	02.16.058.00
32	Rocker Switch, On/Off	02.19.080.00	02.19.080.00	02.19.081.00	02.19.081.00	02.19.081.00	02.19.081.00
33	Air Heating Element (1050 Watts)	R02.05.011.00	R02.05.011.00	R02.05.015.00	R02.05.012.00	R02.05.015.00	R02.05.012.00
34	Blower Motor	02.12.001.00	02.12.001.00	02.12.006.00	02.12.006.00	02.12.006.00	02.12.006.00
35	Rack Motor	02.12.005.00	02.12.005.00	02.12.047.00	02.12.047.00	02.12.047.00	02.12.047.00
36	Power Cord with Plug	02.18.035.00	02.18.082.00	02.18.109.00	02.18.120.00	02.18.109.00	02.18.120.00
37	Indicator Light, Low Water (Red)	02.19.154.00	02.19.154.00	02.19.151.00	02.19.151.00	02.19.151.00	02.19.151.00
38	Indicator Light, Humidity Cycle	02.19.155.00	02.19.155.00	02.19.157.00	02.19.157.00	02.19.157.00	02.19.157.00
39	Ballast	02.30.075.00	02.30.075.00	02.30.080.00	02.30.080.00	02.30.080.00	02.30.080.00
40	Motor Bearing Lube	05.01.018.00	05.01.018.00	05.01.018.00	05.01.018.00	05.01.018.00	05.01.018.00
41	Door*	R04.40.113.00	R04.40.113.00	R04.40.113.00	R04.40.113.00	R04.40.113.00	R04.40.113.00
42	Water Heating Element (325 Watts)	R02.05.006.00	R02.05.006.00	R02.05.016.00	R02.05.013.00	R02.05.016.00	R02.05.013.00
43	Glass Panel (Qty. 3)	04.40.112.00	04.40.112.00	04.40.112.00	04.40.112.00	04.40.112.00	04.40.112.00
44	Tube, Air Diffuser	04.17.629.00	04.17.629.00	04.17.629.00	04.17.629.00	04.17.629.00	04.17.629.00
45	Collar with Pins, Rack	R04.17.615.00	R04.17.615.00	R04.17.615.00	R04.17.615.00	R04.17.615.00	R04.17.615.00
46	Pins, Rack Collar (Qty. 2)	05.04.352.00	05.04.352.00	05.04.352.00	05.04.352.00	05.04.352.00	05.04.352.00
47	Motorless Rack Coupling (not shown)	---	---	---	---	---	---
48	Circle Rack, 3-Tier	04.17.640.00	04.17.640.00	04.17.640.00	04.17.640.00	04.17.640.00	04.17.640.00
	Circle Rack, 4-Tier	---	---	---	---	---	---
	Circle Rack, 5-Tier	---	---	---	---	---	---
49	Pan Rack, 3-Tier	04.17.010.00	04.17.010.00	04.17.010.00	04.17.010.00	04.17.010.00	04.17.010.00
	Pan Rack, 4-Tier	---	---	---	---	---	---
50	Multi-Purpose Rack, 5-Shelf	R04.17.012.01	R04.17.012.01	R04.17.012.01	R04.17.012.01	R04.17.012.01	R04.17.012.01
	Multi-Purpose Rack, 7-Shelf	---	---	---	---	---	---
51	Angle Rack, 3-Shelf	---	---	---	---	---	---
	Angle Rack, 5-Shelf	---	---	---	---	---	---
52	Terminal Block, 3-Pole (not shown)	---	---	---	---	R02.15.030.00	R02.15.030.00
	Electrical Drawing	HS2-3895	HS2-3895	HS2-4294	HS2-4292	HS2-5987	HS2-5986

Shaded area reflects **export models only**.

*All replacement doors are "B" style hinged doors and are retrofitable to all cabinets.

PARTS SPECIFIC TO MODEL FSD-1X

ITEM	DESCRIPTION	120V 60 Hz	120V Canada	220V 50 Hz/60 Hz	240V 50 Hz/60 Hz	220-230V CE 50 Hz/60 Hz	230-240V CE 50 Hz/60 Hz
30	Control Relay	02.01.028.00	02.01.028.00	02.01.043.00	02.01.043.00	02.01.043.00	02.01.043.00
31	Temperature Display	02.16.057.00	02.16.057.00	02.16.058.00	02.16.058.00	02.16.058.00	02.16.058.00
32	Rocker Switch, On/Off	02.19.080.00	02.19.080.00	02.19.081.00	02.19.081.00	02.19.081.00	02.19.081.00
33	Air Heating Element (1050 Watts)	R02.05.011.00	R02.05.011.00	R02.05.015.00	R02.05.012.00	R02.05.015.00	R02.05.012.00
34	Blower Motor	02.12.001.00	02.12.001.00	02.12.006.00	02.12.006.00	02.12.006.00	02.12.006.00
35	Rack Motor	---	---	---	---	---	---
36	Power Cord with Plug	02.18.035.00	02.18.082.00	02.18.109.00	02.18.120.00	02.18.109.00	02.18.120.00
37	Indicator Light, Low Water (Red)	02.19.154.00	02.19.154.00	02.19.151.00	02.19.151.00	02.19.151.00	02.19.151.00
38	Indicator Light, Humidity Cycle	02.19.155.00	02.19.155.00	02.19.157.00	02.19.157.00	02.19.157.00	02.19.157.00
39	Ballast	02.30.075.00	02.30.075.00	02.30.080.00	02.30.080.00	02.30.080.00	02.30.080.00
40	Motor Bearing Lube	---	---	---	---	---	---
41	Door*	R04.40.113.00	R04.40.113.00	R04.40.113.00	R04.40.113.00	R04.40.113.00	R04.40.113.00
42	Water Heating Element (325 Watts)	R02.05.006.00	R02.05.006.00	R02.05.016.00	R02.05.013.00	R02.05.016.00	R02.05.013.00
43	Glass Panel (Qty. 3)	04.40.112.00	04.40.112.00	04.40.112.00	04.40.112.00	04.40.112.00	04.40.112.00
44	Tube, Air Diffuser	04.17.629.00	04.17.629.00	04.17.629.00	04.17.629.00	04.17.629.00	04.17.629.00
45	Collar with Pins, Rack	---	---	---	---	---	---
46	Pins, Rack Collar	05.04.352.00	05.04.352.00	05.04.352.00	05.04.352.00	05.04.352.00	05.04.352.00
47	Motorless Rack Coupling (not shown)	R04.24.087.00	R04.24.087.00	R04.24.087.00	R04.24.087.00	R04.24.087.00	R04.24.087.00
48	Circle Rack, 3-Tier (requires #47)	04.17.640.00	04.17.640.00	04.17.640.00	04.17.640.00	04.17.640.00	04.17.640.00
	Circle Rack, 4-Tier	---	---	---	---	---	---
	Circle Rack, 5-Tier	---	---	---	---	---	---
49	Pan Rack, 3-Tier	04.17.010.00	04.17.010.00	04.17.010.00	04.17.010.00	04.17.010.00	04.17.010.00
	Pan Rack, 4-Tier	---	---	---	---	---	---
50	Multi-Purpose Rack, 5-Shelf	R04.17.012.01	R04.17.012.01	R04.17.012.01	R04.17.012.01	R04.17.012.01	R04.17.012.01
	Multi-Purpose Rack, 7-Shelf	---	---	---	---	---	---
51	Angle Rack, 3-Shelf	---	---	---	---	---	---
	Angle Rack, 5-Shelf	---	---	---	---	---	---
52	Terminal Block, 3-Pole (not shown)	---	---	---	---	R02.15.030.00	R02.15.030.00
	Electrical Drawing	HS2-3895	HS2-3895	HS2-4294	HS2-4292	HS2-5987	HS2-5986

Shaded area reflects **export models only**.

*All replacement doors are "B" style hinged doors and are retrofitable to all cabinets.

PARTS SPECIFIC TO MODEL FSD-2

ITEM	DESCRIPTION	120V 60 Hz	120V Canada	220V 50 Hz/60 Hz	240V 50 Hz/60 Hz	220-230V CE 50 Hz/60 Hz	230-240V CE 50 Hz/60 Hz
30	Control Relay	02.01.028.00	02.01.028.00	02.01.043.00	02.01.043.00	02.01.043.00	02.01.043.00
31	Temperature Display	02.16.057.00	02.16.057.00	02.16.058.00	02.16.058.00	02.16.058.00	02.16.058.00
32	Rocker Switch, On/Off	02.19.080.00	02.19.080.00	02.19.081.00	02.19.081.00	02.19.081.00	02.19.081.00
33	Air Heating Element (1050 Watts)	R02.05.011.00	R02.05.011.00	R02.05.015.00	R02.05.012.00	R02.05.015.00	R02.05.012.00
34	Blower Motor	02.12.001.00	02.12.001.00	02.12.006.00	02.12.006.00	02.12.006.00	02.12.006.00
35	Rack Motor	02.12.005.00	02.12.005.00	02.12.047.00	02.12.047.00	02.12.047.00	02.12.047.00
36	Power Cord with Plug	02.18.035.00	02.18.082.00	02.18.109.00	02.18.120.00	02.18.109.00	02.18.120.00
37	Indicator Light, Low Water (Red)	02.19.154.00	02.19.154.00	02.19.151.00	02.19.151.00	02.19.151.00	02.19.151.00
38	Indicator Light, Humidity Cycle	02.19.155.00	02.19.155.00	02.19.157.00	02.19.157.00	02.19.157.00	02.19.157.00
39	Ballast	02.30.075.00	02.30.075.00	02.30.080.00	02.30.080.00	02.30.080.00	02.30.080.00
40	Motor Bearing Lube	05.01.018.00	05.01.018.00	05.01.018.00	05.01.018.00	05.01.018.00	05.01.018.00
41	Door (Qty. 2)*	R04.40.113.00	R04.40.113.00	R04.40.113.00	R04.40.113.00	R04.40.113.00	R04.40.113.00
42	Water Heating Element (325 Watts)	R02.05.006.00	R02.05.006.00	R02.05.016.00	R02.05.013.00	R02.05.016.00	R02.05.013.00
43	Glass Panel (Qty. 2)	04.40.112.00	04.40.112.00	04.40.112.00	04.40.112.00	04.40.112.00	04.40.112.00
44	Tube, Air Diffuser	04.17.629.00	04.17.629.00	04.17.629.00	04.17.629.00	04.17.629.00	04.17.629.00
45	Collar with Pins, Rack	R04.17.615.00	R04.17.615.00	R04.17.615.00	R04.17.615.00	R04.17.615.00	R04.17.615.00
46	Pins, Rack Collar (Qty. 2)	05.04.352.00	05.04.352.00	05.04.352.00	05.04.352.00	05.04.352.00	05.04.352.00
47	Motorless Rack Coupling (not shown)	---	---	---	---	---	---
48	Circle Rack, 3-Tier	04.17.640.00	04.17.640.00	04.17.640.00	04.17.640.00	04.17.640.00	04.17.640.00
	Circle Rack, 4-Tier	---	---	---	---	---	---
	Circle Rack, 5-Tier	---	---	---	---	---	---
49	Pan Rack, 3-Tier	04.17.010.00	04.17.010.00	04.17.010.00	04.17.010.00	04.17.010.00	04.17.010.00
	Pan Rack, 4-Tier	---	---	---	---	---	---
50	Multi-Purpose Rack, 5-Shelf	R04.17.012.01	R04.17.012.01	R04.17.012.01	R04.17.012.01	R04.17.012.01	R04.17.012.01
	Multi-Purpose Rack, 7-Shelf	---	---	---	---	---	---
51	Angle Rack, 3-Shelf	---	---	---	---	---	---
	Angle Rack, 5-Shelf	---	---	---	---	---	---
52	Terminal Block, 3-Pole (not shown)	---	---	---	---	R02.15.030.00	R02.15.030.00
	Electrical Drawing	HS2-3895	HS2-3895	HS2-4294	HS2-4292	HS2-5897	HS2-5896

Shaded area reflects **export models only**.

*All replacement doors are "B" style hinged doors and are retrofittable to all cabinets.

PARTS SPECIFIC TO MODEL FSD-2X

ITEM	DESCRIPTION	120V 60 Hz	120V Canada	220V 50 Hz/60 Hz	240V 50 Hz/60 Hz	220-230V CE 50 Hz/60 Hz	230-240V CE 50 Hz/60 Hz
30	Control Relay	02.01.028.00	02.01.028.00	02.01.043.00	02.01.043.00	02.01.043.00	02.01.043.00
31	Temperature Display	02.16.057.00	02.16.057.00	02.16.058.00	02.16.058.00	02.16.058.00	02.16.058.00
32	Rocker Switch, On/Off	02.19.080.00	02.19.080.00	02.19.081.00	02.19.081.00	02.19.081.00	02.19.081.00
33	Air Heating Element (1050 Watts)	R02.05.011.00	R02.05.011.00	R02.05.015.00	R02.05.012.00	R02.05.015.00	R02.05.012.00
34	Blower Motor	02.12.001.00	02.12.001.00	02.12.006.00	02.12.006.00	02.12.006.00	02.12.006.00
35	Rack Motor	---	---	---	---	---	---
36	Power Cord with Plug	02.18.035.00	02.18.082.00	02.18.109.00	02.18.120.00	02.18.109.00	02.18.120.00
37	Indicator Light, Low Water (Red)	02.19.154.00	02.19.154.00	02.19.151.00	02.19.151.00	02.19.151.00	02.19.151.00
38	Indicator Light, Humidity Cycle	02.19.155.00	02.19.155.00	02.19.157.00	02.19.157.00	02.19.157.00	02.19.157.00
39	Ballast	02.30.075.00	02.30.075.00	02.30.080.00	02.30.080.00	02.30.080.00	02.30.080.00
40	Motor Bearing Lube	---	---	---	---	---	---
41	Door (Qty. 2)*	R04.40.113.00	R04.40.113.00	R04.40.113.00	R04.40.113.00	R04.40.113.00	R04.40.113.00
42	Water Heating Element (325 Watts)	R02.05.006.00	R02.05.006.00	R02.05.016.00	R02.05.013.00	R02.05.016.00	R02.05.013.00
43	Glass Panel (Qty. 2)	04.40.112.00	04.40.112.00	04.40.112.00	04.40.112.00	04.40.112.00	04.40.112.00
44	Tube, Air Diffuser	04.17.629.00	04.17.629.00	04.17.629.00	04.17.629.00	04.17.629.00	04.17.629.00
45	Collar with Pins, Rack	---	---	---	---	---	---
46	Pins, Rack Collar	05.04.352.00	05.04.352.00	05.04.352.00	05.04.352.00	05.04.352.00	05.04.352.00
47	Motorless Rack Coupling (not shown)	R04.24.087.00	R04.24.087.00	R04.24.087.00	R04.24.087.00	R04.24.087.00	R04.24.087.00
48	Circle Rack, 3-Tier (requires #47)	04.17.640.00	04.17.640.00	04.17.640.00	04.17.640.00	04.17.640.00	04.17.640.00
	Circle Rack, 4-Tier	---	---	---	---	---	---
	Circle Rack, 5-Tier	---	---	---	---	---	---
49	Pan Rack, 3-Tier	04.17.010.00	04.17.010.00	04.17.010.00	04.17.010.00	04.17.010.00	04.17.010.00
	Pan Rack, 4-Tier	---	---	---	---	---	---
50	Multi-Purpose Rack, 5-Shelf	R04.17.012.01	R04.17.012.01	R04.17.012.01	R04.17.012.01	R04.17.012.01	R04.17.012.01
	Multi-Purpose Rack, 7-Shelf	---	---	---	---	---	---
51	Angle Rack, 3-Shelf	---	---	---	---	---	---
	Angle Rack, 5-Shelf	---	---	---	---	---	---
52	Terminal Block, 3- Pole (not shown)	---	---	---	---	R02.15.030.00	R02.15.030.00
	Electrical Drawing	HS2-3895	HS2-3895	HS2-4294	HS2-4292	HS2-5897	HS2-5896

Shaded area reflects **export models only**.

*All replacement doors are "B" style hinged doors and are retrofitable to all cabinets.

PARTS SPECIFIC TO MODEL FSDT-1

ITEM	DESCRIPTION	120V 60 Hz	120V Canada	220V 50 Hz/60 Hz	240V 50 Hz/60 Hz	220-230V CE 50 Hz/60 Hz	230-240V CE 50 Hz/60 Hz
30	Control Relay	02.01.028.00	02.01.028.00	02.01.043.00	02.01.043.00	02.01.043.00	02.01.043.00
31	Temperature Display	02.16.057.00	02.16.057.00	02.16.058.00	02.16.058.00	02.16.058.00	02.16.058.00
32	Rocker Switch, On/Off	02.19.080.00	02.19.080.00	02.19.081.00	R2.19.081.00	02.19.081.00	R2.19.081.00
33	Air Heating Element (1050 Watts)	R02.05.011.00	R02.05.011.00	R02.05.015.00	R02.05.012.00	R02.05.015.00	R02.05.012.00
34	Blower Motor	02.12.001.00	02.12.001.00	02.12.006.00	02.12.006.00	02.12.006.00	02.12.006.00
35	Rack Motor	02.12.005.00	02.12.005.00	02.12.047.00	02.12.047.00	02.12.047.00	02.12.047.00
36	Power Cord with Plug	02.18.035.00	02.18.082.00	02.18.109.00	02.18.120.00	02.18.109.00	02.18.120.00
37	Indicator Light, Low Water (Red)	02.19.154.00	02.19.154.00	02.19.151.00	02.19.151.00	02.19.151.00	02.19.151.00
38	Indicator Light, Humidity Cycle	02.19.155.00	02.19.155.00	02.19.157.00	02.19.157.00	02.19.157.00	02.19.157.00
39	Ballast	02.30.075.00	02.30.075.00	02.30.080.00	02.30.080.00	02.30.080.00	02.30.080.00
40	Motor Bearing Lube	05.01.018.00	05.01.018.00	05.01.018.00	05.01.018.00	05.01.018.00	05.01.018.00
41	Door*	R04.40.115.00	R04.40.115.00	R04.40.115.00	R04.40.115.00	R04.40.115.00	R04.40.115.00
42	Water Heating Element (325 Watts)	R02.05.006.00	R02.05.006.00	R02.05.016.00	R02.05.013.00	R02.05.016.00	R02.05.013.00
43	Glass Panel (Qty. 3)	04.40.114.00	04.40.114.00	04.40.114.00	04.40.114.00	04.40.114.00	04.40.114.00
44	Tube, Air Diffuser	04.17.627.00	04.17.627.00	04.17.627.00	04.17.627.00	04.17.627.00	04.17.627.00
45	Collar with Pins, Rack	R04.17.615.00	R04.17.615.00	R04.17.615.00	R04.17.615.00	R04.17.615.00	R04.17.615.00
46	Pins, Rack Collar (Qty. 2)	05.04.352.00	05.04.352.00	05.04.352.00	05.04.352.00	05.04.352.00	05.04.352.00
47	Motorless Rack Coupling (not shown)	---	---	---	---	---	---
48	Circle Rack, 3-Tier	---	---	---	---	---	---
	Circle Rack, 4-Tier	04.17.641.00	04.17.641.00	04.17.641.00	04.17.641.00	04.17.641.00	04.17.641.00
	Circle Rack, 5-Tier	04.17.642.00	04.17.642.00	04.17.642.00	04.17.642.00	04.17.642.00	04.17.642.00
49	Pan Rack, 3-Tier	04.17.010.00	04.17.010.00	04.17.010.00	04.17.010.00	04.17.010.00	04.17.010.00
	Pan Rack, 4-Tier	04.17.027.00	04.17.027.00	04.17.027.00	04.17.027.00	04.17.027.00	04.17.027.00
50	Multi-Purpose Rack, 5-Shelf	---	---	---	---	---	---
	Multi-Purpose Rack, 7-Shelf	R04.17.012.00	R04.17.012.00	R04.17.012.00	R04.17.012.00	R04.17.012.00	R04.17.012.00
51	Angle Rack, 3-Shelf	R04.17.013.00	R04.17.013.00	R04.17.013.00	R04.17.013.00	R04.17.013.00	R04.17.013.00
	Angle Rack, 5-Shelf	R04.17.019.00	R04.17.019.00	R04.17.019.00	R04.17.019.00	R04.17.019.00	R04.17.019.00
52	Terminal Block, 3-Pole (not shown)	---	---	---	---	R02.15.030.00	R02.15.030.00
	Electrical Drawing	HS2-3895	HS2-3895	HS2-4294	HS2-4292	HS2-5897	HS2-5896

Shaded area reflects **export models only**.

*All replacement doors are "B" style hinged doors and are retrofitable to all cabinets.

PARTS SPECIFIC TO MODEL FSDT-1X

ITEM	DESCRIPTION	120V 60 Hz	120V Canada	220V 50 Hz/60 Hz	240V 50 Hz/60 Hz	220-230V CE 50 Hz/60 Hz	230-240V CE 50 Hz/60 Hz
30	Control Relay	02.01.028.00	02.01.028.00	02.01.043.00	02.01.043.00	02.01.043.00	02.01.043.00
31	Temperature Display	02.16.057.00	02.16.057.00	02.16.058.00	02.16.058.00	02.16.058.00	02.16.058.00
32	Rocker Switch, On/Off	02.19.080.00	02.19.080.00	02.19.081.00	02.19.081.00	02.19.081.00	02.19.081.00
33	Air Heating Element (1050 Watts)	R02.05.011.00	R02.05.011.00	R02.05.015.00	R02.05.012.00	R02.05.015.00	R02.05.012.00
34	Blower Motor	02.12.001.00	02.12.001.00	02.12.006.00	02.12.006.00	02.12.006.00	02.12.006.00
35	Rack Motor	---	---	---	---	---	---
36	Power Cord with Plug	02.18.035.00	02.18.082.00	02.18.109.00	02.18.120.00	02.18.109.00	02.18.120.00
37	Indicator Light, Low Water (Red)	02.19.154.00	02.19.154.00	02.19.151.00	02.19.151.00	02.19.151.00	02.19.151.00
38	Indicator Light, Humidity Cycle	02.19.155.00	02.19.155.00	02.19.157.00	02.19.157.00	02.19.157.00	02.19.157.00
39	Ballast	02.30.075.00	02.30.075.00	02.30.080.00	02.30.080.00	02.30.080.00	02.30.080.00
40	Motor Bearing Lube	---	---	---	---	---	---
41	Door*	R04.40.115.00	R04.40.115.00	R04.40.115.00	R04.40.115.00	R04.40.115.00	R04.40.115.00
42	Water Heating Element (325 Watts)	R02.05.006.00	R02.05.006.00	R02.05.016.00	R02.05.013.00	R02.05.016.00	R02.05.013.00
43	Glass Panel (Qty. 3)	04.40.114.00	04.40.114.00	04.40.114.00	04.40.114.00	04.40.114.00	04.40.114.00
44	Tube, Air Diffuser	04.17.627.00	04.17.627.00	04.17.627.00	04.17.627.00	04.17.627.00	04.17.627.00
45	Collar with Pins, Rack	---	---	---	---	---	---
46	Pins, Rack Collar	05.04.352.00	05.04.352.00	05.04.352.00	05.04.352.00	05.04.352.00	05.04.352.00
47	Motorless Rack Coupling (not shown)	R04.24.087.00	R04.24.087.00	R04.24.087.00	R04.24.087.00	R04.24.087.00	R04.24.087.00
48	Circle Rack, 3-Tier	---	---	---	---	---	---
	Circle Rack, 4-Tier (requires #47)	04.17.641.00	04.17.641.00	04.17.641.00	04.17.641.00	04.17.641.00	04.17.641.00
	Circle Rack, 5-Tier (requires #47)	04.17.642.00	04.17.642.00	04.17.642.00	04.17.642.00	04.17.642.00	04.17.642.00
49	Pan Rack, 3-Tier	04.17.010.00	04.17.010.00	04.17.010.00	04.17.010.00	04.17.010.00	04.17.010.00
	Pan Rack, 4-Tier	04.17.027.00	04.17.027.00	04.17.027.00	04.17.027.00	04.17.027.00	04.17.027.00
50	Multi-Purpose Rack, 5-Shelf	---	---	---	---	---	---
	Multi-Purpose Rack, 7-Shelf	R04.17.012.00	R04.17.012.00	R04.17.012.00	R04.17.012.00	R04.17.012.00	R04.17.012.00
51	Angle Rack, 3-Shelf	R04.17.013.00	R04.17.013.00	R04.17.013.00	R04.17.013.00	R04.17.013.00	R04.17.013.00
	Angle Rack, 5-Shelf	R04.17.019.00	R04.17.019.00	R04.17.019.00	R04.17.019.00	R04.17.019.00	R04.17.019.00
52	Terminal Block, 3-Pole (not shown)	---	---	---	---	R02.15.030.00	R02.15.030.00
	Electrical Drawing	HS2-3895	HS2-3895	HS2-4294	HS2-4292	HS2-5897	HS2-5896

Shaded area reflects **export models only**.

*All replacement doors are "B" style hinged doors and are retrofitable to all cabinets.

PARTS SPECIFIC TO MODEL FSDT-2

ITEM	DESCRIPTION	120V 60 Hz	120V Canada	220V 50 Hz/60 Hz	240V 50 Hz/60Hz	220-230V CE 50 Hz/60 Hz	230-240V CE 50 Hz/60 Hz
30	Control Relay	02.01.028.00	02.01.028.00	02.01.043.00	02.01.043.00	02.01.043.00	02.01.043.00
31	Temperature Display	02.16.057.00	02.16.057.00	02.16.058.00	02.16.058.00	02.16.058.00	02.16.058.00
32	Rocker Switch, On/Off	02.19.080.00	02.19.080.00	02.19.081.00	02.19.081.00	02.19.081.00	02.19.081.00
33	Air Heating Element (1050 Watts)	R02.05.011.00	R02.05.011.00	R02.05.015.00	R02.05.012.00	R02.05.015.00	R02.05.012.00
34	Blower Motor	02.12.001.00	02.12.001.00	02.12.006.00	02.12.006.00	02.12.006.00	02.12.006.00
35	Rack Motor	02.12.005.00	02.12.005.00	02.12.047.00	02.12.047.00	02.12.047.00	02.12.047.00
36	Power Cord with Plug	02.18.035.00	02.18.082.00	02.18.109.00	02.18.120.00	02.18.109.00	02.18.120.00
37	Indicator Light, Low Water (Red)	02.19.154.00	02.19.154.00	02.19.151.00	02.19.151.00	02.19.151.00	02.19.151.00
38	Indicator Light, Humidity Cycle	02.19.155.00	02.19.155.00	02.19.157.00	02.19.157.00	02.19.157.00	02.19.157.00
39	Ballast	02.30.075.00	02.30.075.00	02.30.080.00	02.30.080.00	02.30.080.00	02.30.080.00
40	Motor Bearing Lube	05.01.018.00	05.01.018.00	05.01.018.00	05.01.018.00	05.01.018.00	05.01.018.00
41	Door (Qty. 2)*	R04.40.115.00	R04.40.115.00	R04.40.115.00	R04.40.115.00	R04.40.115.00	R04.40.115.00
42	Water Heating Element (325 Watts)	R02.05.006.00	R02.05.006.00	R02.05.016.00	R02.05.013.00	R02.05.016.00	R02.05.013.00
43	Glass Panel (Qty. 2)	04.40.114.00	04.40.114.00	04.40.114.00	04.40.114.00	04.40.114.00	04.40.114.00
44	Tube, Air Diffuser	04.17.627.00	04.17.627.00	04.17.627.00	04.17.627.00	04.17.627.00	04.17.627.00
45	Collar with Pins, Rack	R04.17.615.00	R04.17.615.00	R04.17.615.00	R04.17.615.00	R04.17.615.00	R04.17.615.00
46	Pins, Rack Collar (Qty. 2)	05.04.352.00	05.04.352.00	05.04.352.00	05.04.352.00	05.04.352.00	05.04.352.00
47	Motorless Rack Coupling (not shown)	---	---	---	---	---	---
48	Circle Rack, 3-Tier	---	---	---	---	---	---
	Circle Rack, 4-Tier	04.17.641.00	04.17.641.00	04.17.641.00	04.17.641.00	04.17.641.00	04.17.641.00
	Circle Rack, 5-Tier	04.17.642.00	04.17.642.00	04.17.642.00	04.17.642.00	04.17.642.00	04.17.642.00
49	Pan Rack, 3-Tier	04.17.010.00	04.17.010.00	04.17.010.00	04.17.010.00	04.17.010.00	04.17.010.00
	Pan Rack, 4-Tier	04.17.027.00	04.17.027.00	04.17.027.00	04.17.027.00	04.17.027.00	04.17.027.00
50	Multi-Purpose Rack, 5-Shelf	---	---	---	---	---	---
	Multi-Purpose Rack, 7-Shelf	R04.17.012.00	R04.17.012.00	R04.17.012.00	R04.17.012.00	R04.17.012.00	R04.17.012.00
51	Angle Rack, 3-Shelf	R04.17.013.00	R04.17.013.00	R04.17.013.00	R04.17.013.00	R04.17.013.00	R04.17.013.00
	Angle Rack, 5-Shelf	R04.17.019.00	R04.17.019.00	R04.17.019.00	R04.17.019.00	R04.17.019.00	R04.17.019.00
52	Terminal Block, 3-Pole (not shown)	---	---	---	---	R02.15.030.00	R02.15.030.00
	Electrical Drawing	HS2-3895	HS2-3895	HS2-4294	HS2-4292	HS2-5897	HS2-5896

Shaded area reflects **export models only**.

*All replacement doors are "B" style hinged doors and are retrofitable to all cabinets.

PARTS SPECIFIC TO MODEL FSDT-2X

ITEM	DESCRIPTION	120V 60 Hz	120V Canada	220V 50 Hz/60 Hz	240V 50 Hz/60 Hz	220-230V CE 50 Hz/60 Hz	230-240V CE 50 Hz/60 Hz
30	Control Relay	02.01.028.00	02.01.028.00	02.01.043.00	02.01.043.00	02.01.043.00	02.01.043.00
31	Temperature Display	02.16.057.00	02.16.057.00	02.16.058.00	02.16.058.00	02.16.058.00	02.16.058.00
32	Rocker Switch, On/Off	02.19.080.00	02.19.080.00	02.19.081.00	02.19.081.00	02.19.081.00	02.19.081.00
33	Air Heating Element (1050 Watts)	R02.05.011.00	R02.05.011.00	R02.05.015.00	R02.05.012.00	R02.05.015.00	R02.05.012.00
34	Blower Motor	02.12.001.00	02.12.001.00	02.12.006.00	02.12.006.00	02.12.006.00	02.12.006.00
35	Rack Motor	---	---	---	---	---	---
36	Power Cord with Plug	02.18.035.00	02.18.082.00	02.18.109.00	02.18.120.00	02.18.109.00	02.18.120.00
37	Indicator Light, Low Water (Red)	02.19.154.00	02.19.154.00	02.19.151.00	02.19.151.00	02.19.151.00	02.19.151.00
38	Indicator Light, Humidity Cycle	02.19.155.00	02.19.155.00	02.19.157.00	02.19.157.00	02.19.157.00	02.19.157.00
39	Ballast	02.30.075.00	02.30.075.00	02.30.080.00	02.30.080.00	02.30.080.00	02.30.080.00
40	Motor Bearing Lube	---	---	---	---	---	---
41	Door (Qty. 2)*	R04.40.115.00	R04.40.115.00	R04.40.115.00	R04.40.115.00	R04.40.115.00	R04.40.115.00
42	Water Heating Element (325 Watts)	R02.05.006.00	R02.05.006.00	R02.05.016.00	R02.05.013.00	R02.05.016.00	R02.05.013.00
43	Glass Panel (Qty. 2)	04.40.114.00	04.40.114.00	04.40.114.00	04.40.114.00	04.40.114.00	04.40.114.00
44	Tube, Air Diffuser	04.17.629.00	04.17.629.00	04.17.629.00	04.17.629.00	04.17.629.00	04.17.629.00
45	Collar with Pins, Rack	---	---	---	---	---	---
46	Pins, Rack Collar	05.04.352.00	05.04.352.00	05.04.352.00	05.04.352.00	05.04.352.00	05.04.352.00
47	Motorless Rack Coupling (not shown)	R04.24.087.00	R04.24.087.00	R04.24.087.00	R04.24.087.00	R04.24.087.00	R04.24.087.00
48	Circle Rack, 3-Tier	---	---	---	---	---	---
	Circle Rack, 4-Tier (requires #47)	04.17.641.00	04.17.641.00	04.17.641.00	04.17.641.00	04.17.641.00	04.17.641.00
	Circle Rack, 5-Tier (requires #47)	04.17.642.00	04.17.642.00	04.17.642.00	04.17.642.00	04.17.642.00	04.17.642.00
49	Pan Rack, 3-Tier	04.17.010.00	04.17.010.00	04.17.010.00	04.17.010.00	04.17.010.00	04.17.010.00
	Pan Rack, 4-Tier	04.17.027.00	04.17.027.00	04.17.027.00	04.17.027.00	04.17.027.00	04.17.027.00
50	Multi-Purpose Rack, 5-Shelf	---	---	---	---	---	---
	Multi-Purpose Rack, 7-Shelf	R04.17.012.00	R04.17.012.00	R04.17.012.00	R04.17.012.00	R04.17.012.00	R04.17.012.00
51	Angle Rack, 3-Shelf	R04.17.013.00	R04.17.013.00	R04.17.013.00	R04.17.013.00	R04.17.013.00	R04.17.013.00
	Angle Rack, 5-Shelf	R04.17.019.00	R04.17.019.00	R04.17.019.00	R04.17.019.00	R04.17.019.00	R04.17.019.00
52	Terminal Block, 3-Pole (not shown)	---	---	---	---	R02.15.030.00	R02.15.030.00
	Electrical Drawing	HS2-3895	HS2-3895	HS2-4294	HS2-4292	HS2-5897	HS2-5896

Shaded area reflects **export models only**.

*All replacement doors are "B" style hinged doors and are retrofitable to all cabinets.